

Montageanleitung

Construction Manual

Notice de montage

VERSION

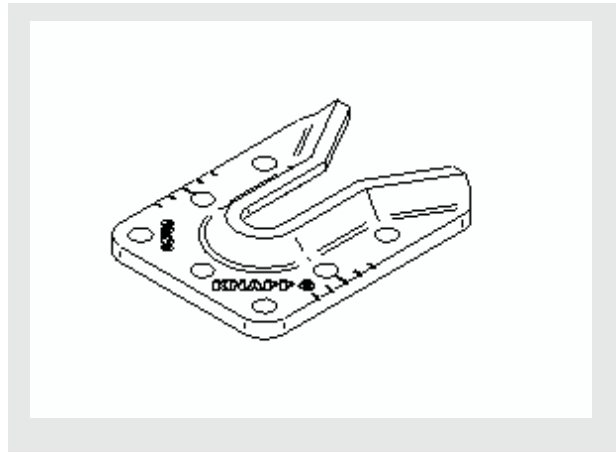

Art.-Nr.

WALCO® V 60x80

Wandverbinder

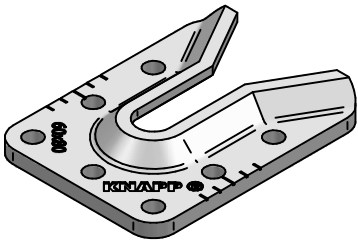

Kragenschraube 12x60 mm
Art. - Nr. K102



WALCO V 60x80



1. Bohren

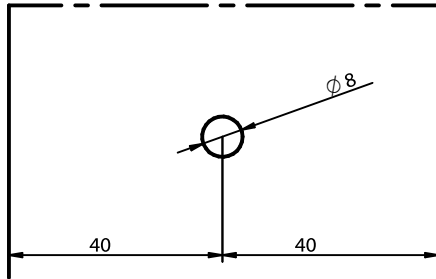

2. Eindrehen der Kragenschraube

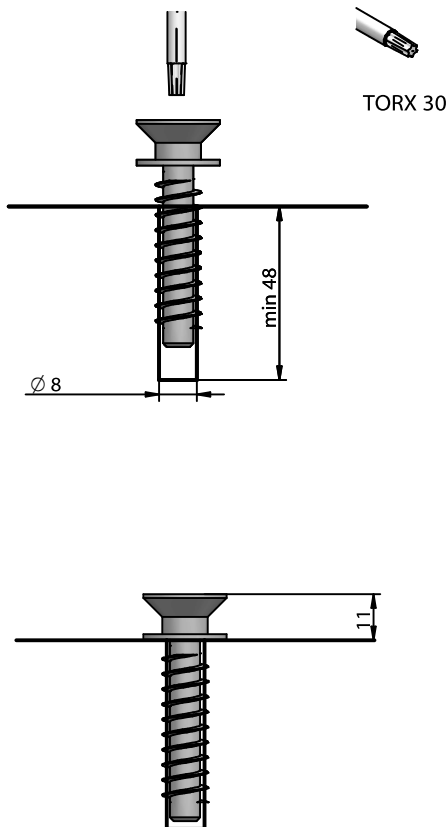

Hinweis: Wenn der Verbinder in der Beplankungsebene montiert wird, kann durch Verwendung einer zusätzlichen DIN 125 M12 Unterlegscheibe an eine 15mm Beplankung angepasst werden.

1. Ausfräsung herstellen

Mindest- Ausfräsmaße (Alternativ kann der Verbinder auch in der Beplankungsebene 13mm oder 15mm untergebracht werden.)

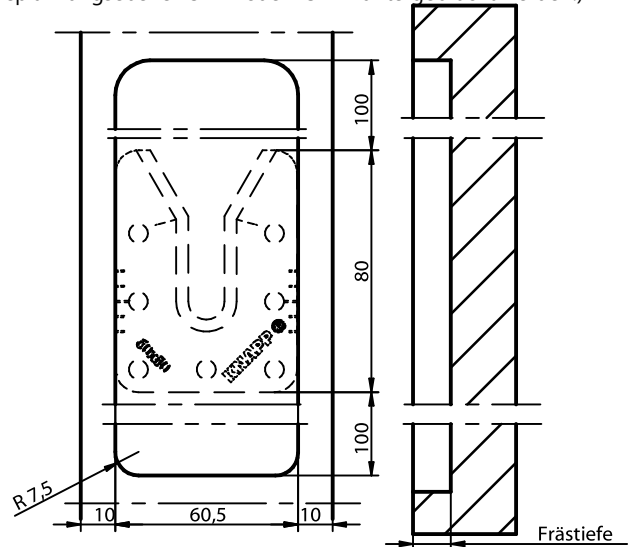

Halteschraube	Einfrästiefe
Kragenschraube	13 mm fugenlose stramme Montage 11 mm leichtes Einhängen (2 mm Fuge)
Einstellbare Halteschraube	11 - 22 mm
Gefederte Halteschraube	11- 17 mm

2. Verbinderposition mit Anreißschablone anreißern

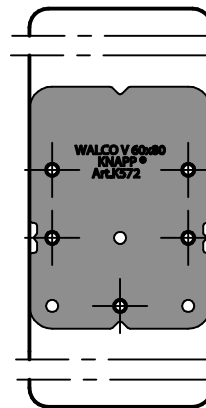

Ø 4 Tiefe 50mm
alternativ Ø 5 Tiefe 10mm

Art. - Nr. K572

3. Verbinder montieren

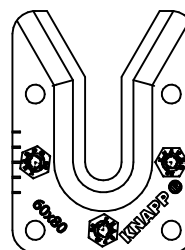

Standard:
3x Sechskantschrauben 6x50 mm

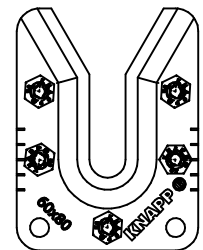

Spezial:
5x Sechskantschrauben 6x50 mm

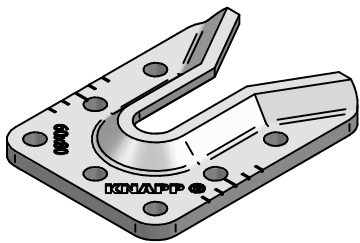

Gefederte Halteschraube M12
Art. - Nr. K106



1. Bohren

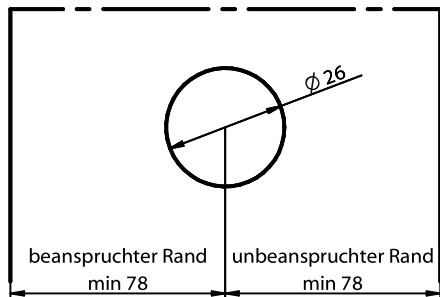

2. Eindrehen der Einschraubmutter mit Eindrehwerkzeug

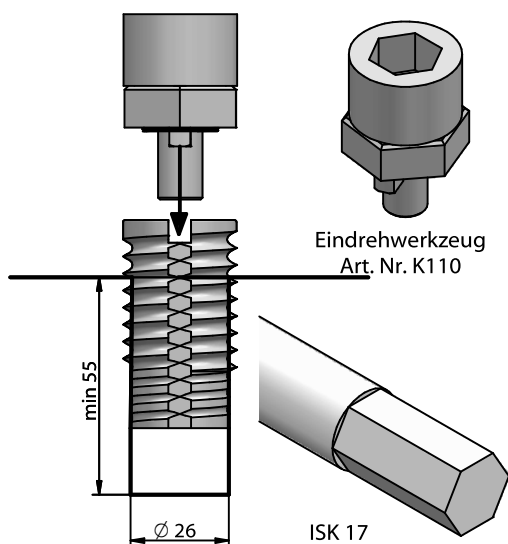

3. Halteschraube M12 eindrehen und auf Höhe justieren

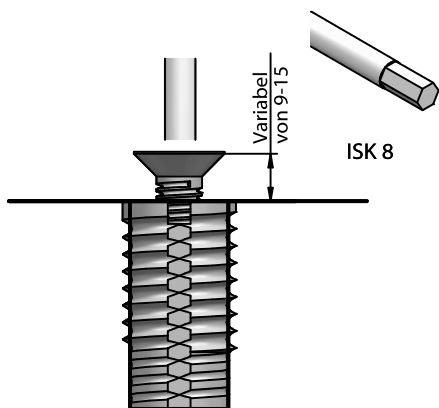

Einstellbare Halteschraube M12
Art. - Nr. K104



1. Stufenbohrung erstellen

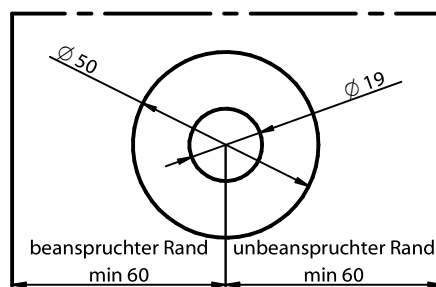

2. Eindrehen der Einschraubmutter

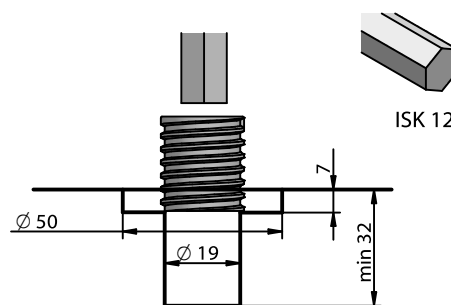

3. Eindrehen der Halteschraube incl. Mutter M12

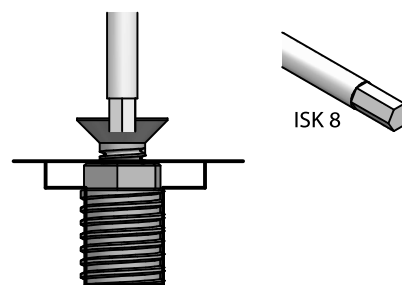

4. Höhe justieren und Schraube mit Mutter fixieren

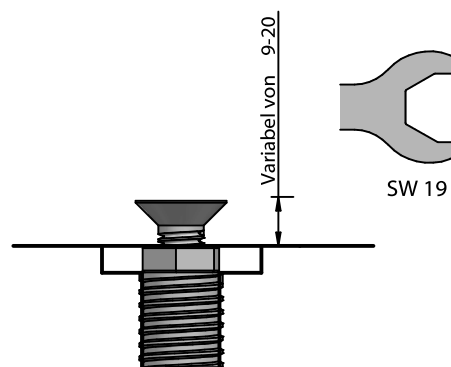

Diese Zeichnung ist Eigentum der Knapp GmbH

© Knapp GmbH. Alle Maße in mm - Irrtümer, Druckfehler und Änderungen vorbehalten / all measures in mm - Errors excepted. VERSION 11.05.2026

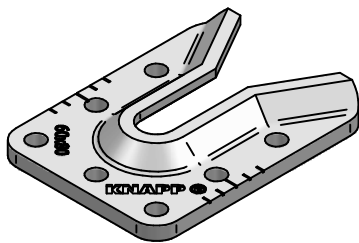

Verschraubter Kragenbolzen

Art. - Nr. K108



1. Bohren

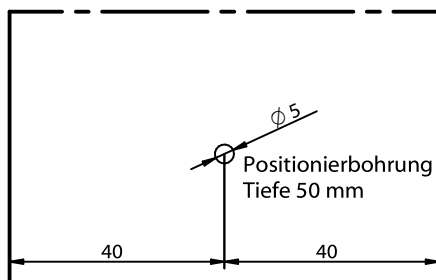

2. Eindrehen der Schraube in den Kragenbolzen

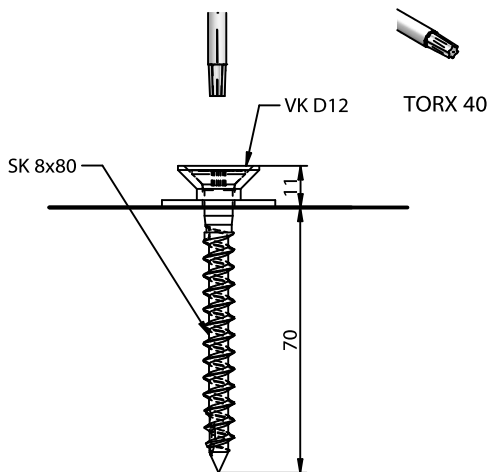

Hinweis:

Die Vollgewindeschraube kann auch mit einem $\varnothing 5$ mm Bohrer vorgebohrt werden!
 Wenn der Verbinder in der Beplankungsebene montiert wird, kann durch Verwendung einer zusätzlichen DIN 125 M12 Unterlegscheibe an eine 15mm Beplankung angepasst werden.

WALCO V 60x80

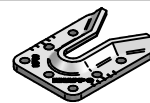

1. Ausfräsung herstellen

Mindest- Ausfräsmaße (Alternativ kann der Verbinder auch in der Beplankungsebene 13mm oder 15mm untergebracht werden.)

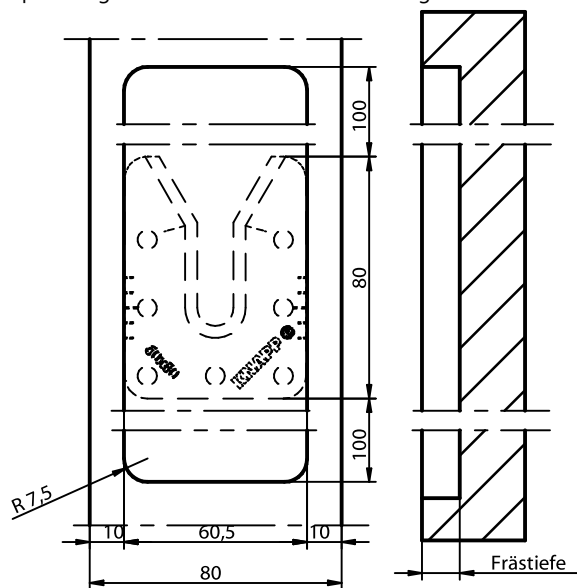

Frästiefe:
 13 mm für fugenlose stramme Montage
 11 mm für leichtes Einhängen (mit 2 mm Fuge)

2. Verbinderposition mit Anreißschablone anreißern

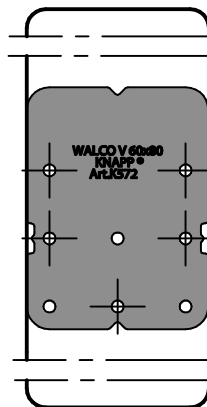

$\varnothing 4$ Tiefe 50mm
 alternativ $\varnothing 5$ Tiefe 10mm

Art. - Nr. K572

3. Verbinder montieren

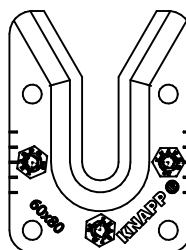

Standard:
 3x Sechskantschrauben 6x50 mm

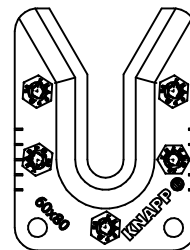

Spezial:
 5x Sechskantschrauben 6x50 mm

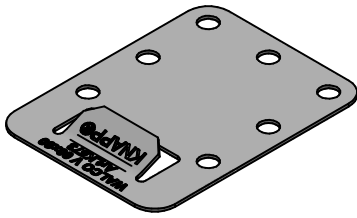

Montageanleitung

WALCO® V 60x80

Wandverbinder mit Sperrklappe

WALCO V 60x80 Sperrklappe
Art. - Nr. K573

WALCO V 60x80

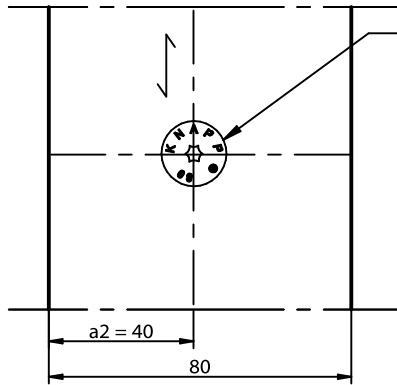
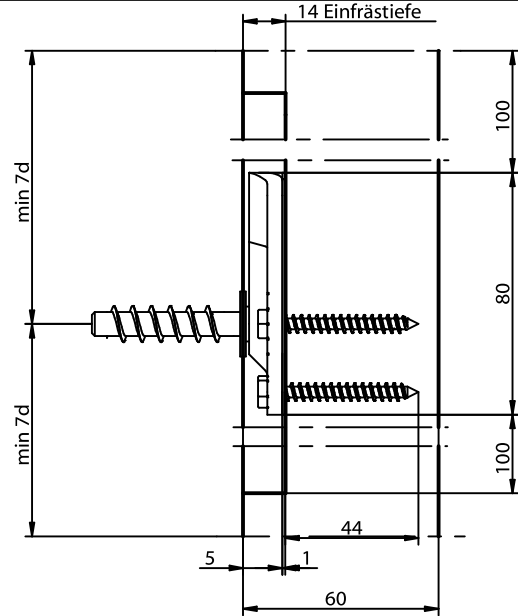
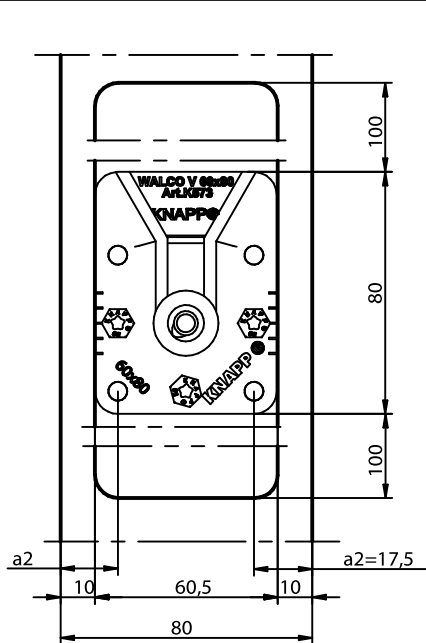

Kragenschraube 12x60 mm

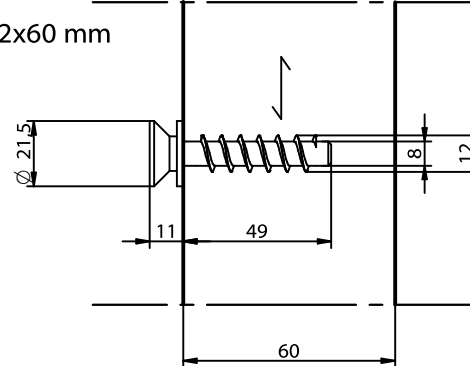

1. Positionieren

2. Einführen

3. Verriegeln

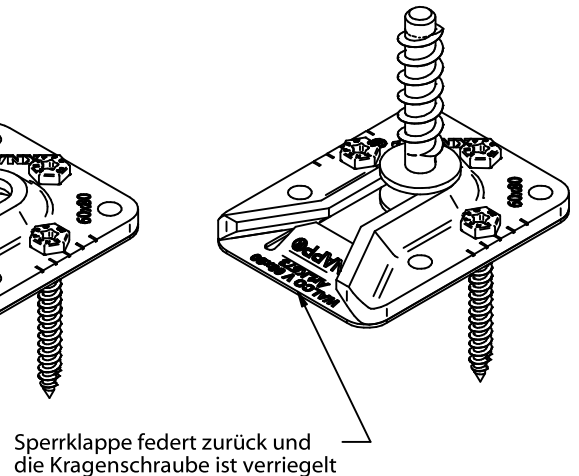
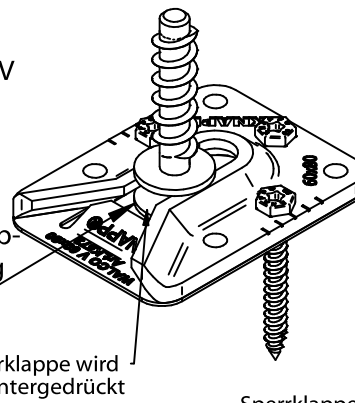
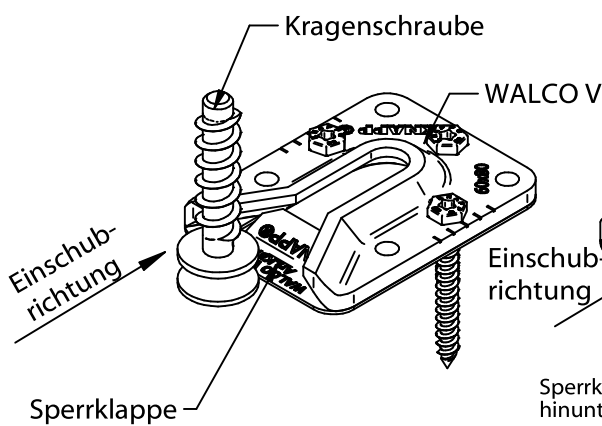

Diese Zeichnung ist Eigentum der Knapp GmbH

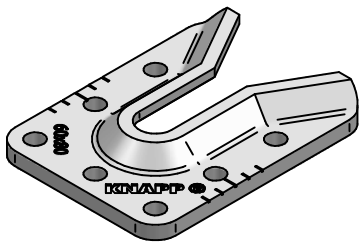

Assembly Instructions

WALCO® V 60x80

Wall connector

Collar Screw 12x60 mm
Art. - No. K102



WALCO V 60x80



1. Drilling

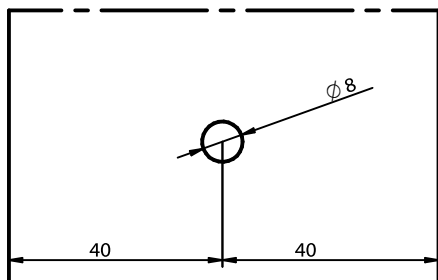

2. Screwing collar screw

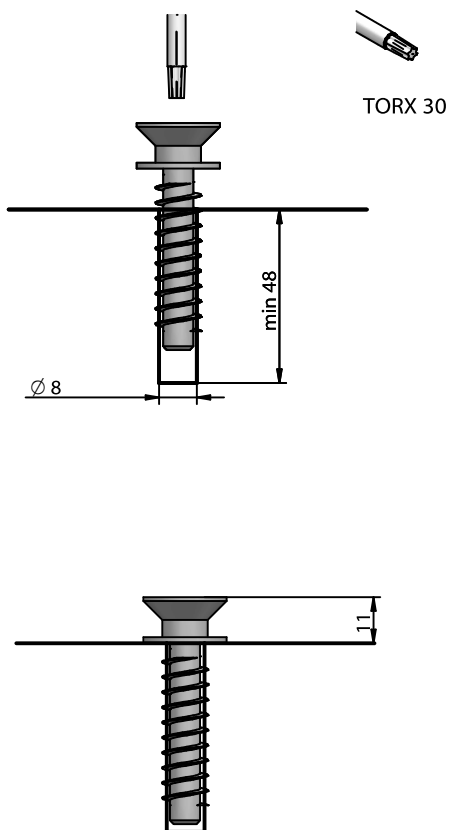

Note: If the connector is installed in the sheeting level, it can be adapted to 15mm sheeting by using an additional DIN 125 M12 washer.

1. Machined edge

Minimum milling dimensions (alternatively, the connector can also be accommodated in the sheeting level 13 mm or 15 mm)

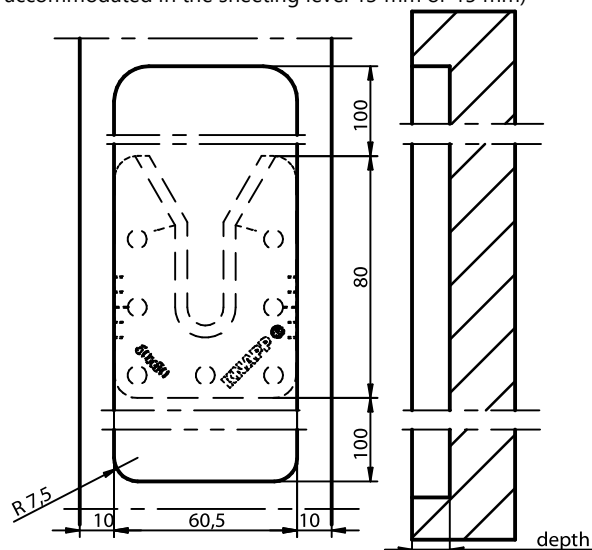

Holding screw	Depth T
Collar screw	13 mm without joint=> tight fitting 11 mm easy to connect (2 mm gap)
Retaining holding screw	11 - 22 mm
Retaining spring holding screw	11 - 17 mm

2. Marking Connector position with scribing jig

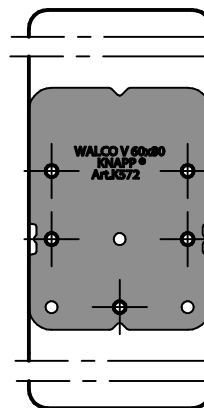

Ø 4 depth 50mm
alternativ Ø 5 depth 10mm

Art. - No. K572

3. Assemble connector

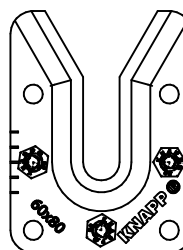

Standard:
3x Hex-head-wood screws 6x50 mm

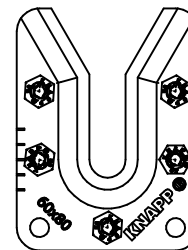

Special:
5x Hex-head-wood screws 6x50 mm

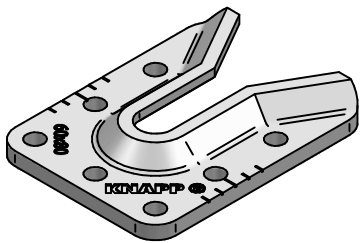

Assembly Instructions

WALCO® V 60x80

Wall connector

Retaining spring holding screw
M12 Art. - No. K106



1. Drilling

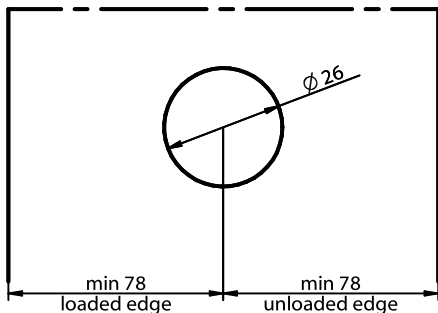

2. Screwing the insert screw with special tool

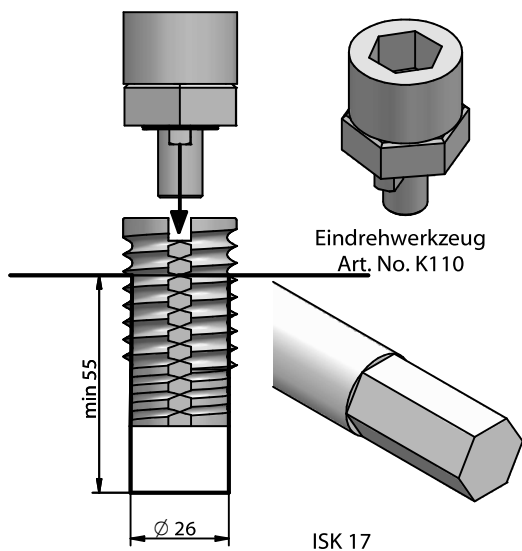

3. Screwing holding screw and adjustment of height

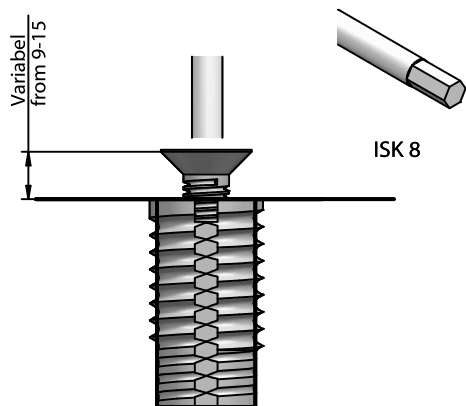

Retaining holding screw M12
Art. - No. K104



1. Drilling the two holes

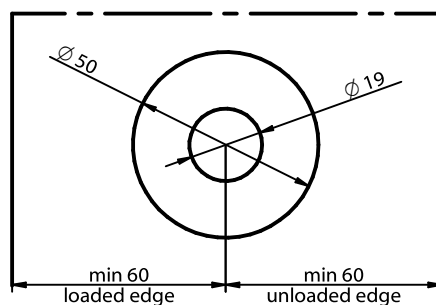

2. Screwing insert screw

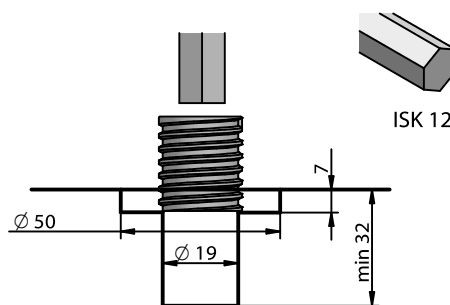

3. Screwing retaining holding screw and nut M12

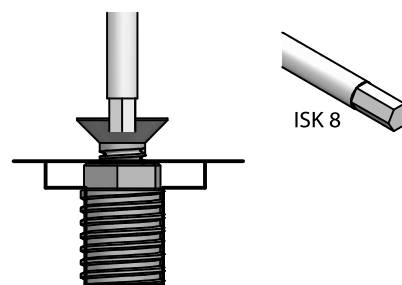

4. Fixing the screw and nut in the ideal position

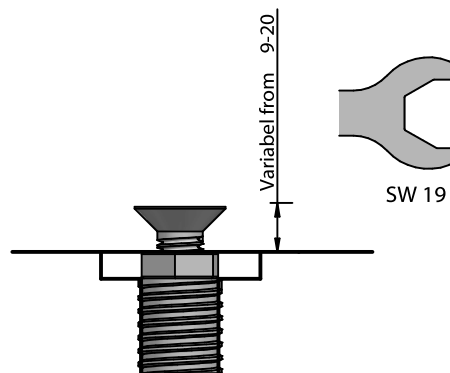

This drawing is the exclusive property of Knapp GmbH.

© Knapp GmbH. All measures in mm - Errors excepted. VERSION 11.05.2026

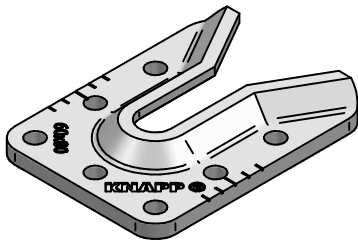

Assembly Instructions

WALCO® V 60x80 VK D12

Wall connector

Collar bolt holding screw
Art. - No. K108



WALCO V 60x80



1. Drilling

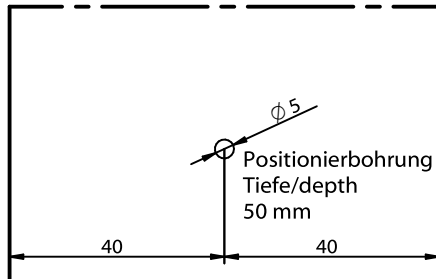

2. Screwing countersink screw into Collar bolt

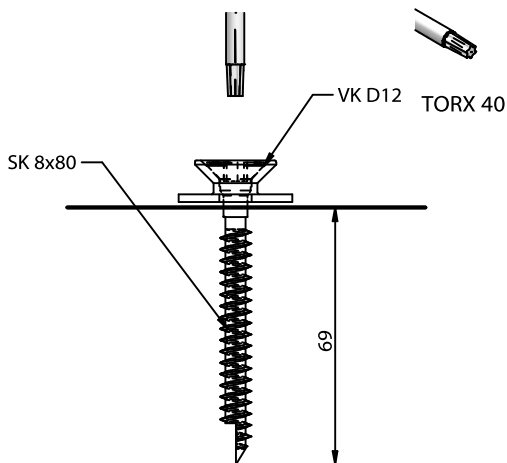

Hinweis: The fully threaded screw can also be pre-drilled with a Ø5 mm drill !

If the connector is installed in the sheeting level, it can be adapted to 15mm sheeting by using an additional DIN 125 M12 washer.

1. Machined edge

Minimum milling dimensions (alternatively, the connector can also be accommodated in the sheeting level 13 mm or 15 mm)

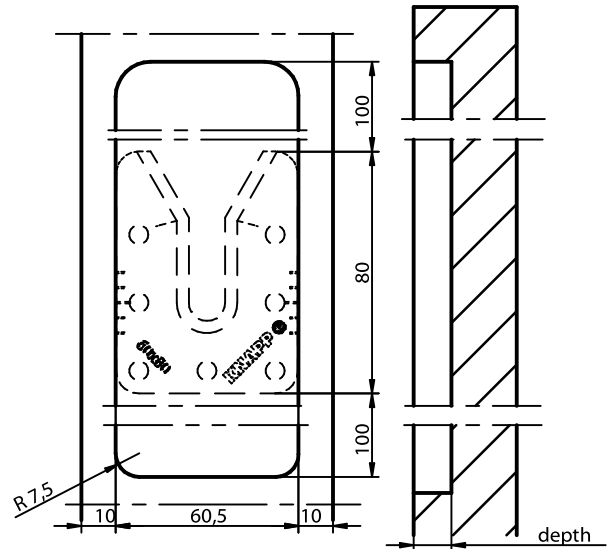

Depth: 13 mm without joint => tight fitting
11 mm easy to connect (2 mm gap)

2. Marking Connector position with scribing jig

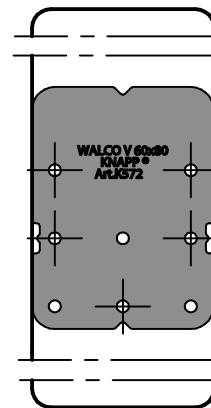

Ø 4 depth 50mm
alternativ Ø 5 depth 10mm

Art. No. K572

3. Assemble connector

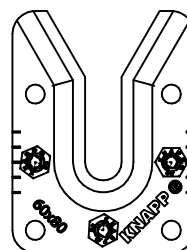

Standard:
3x Hex-head-wood screws 6x50 mm

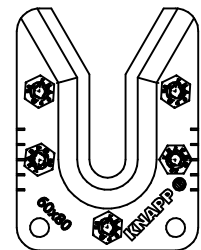

Special:
5x Hex-head-wood screws 6x50 mm

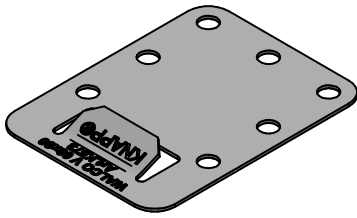

Assembly Instructions

WALCO® V 60x80

Wall connector with clip lock

WALCO V Clip lock
Art. - No. K573

WALCO V 60x80

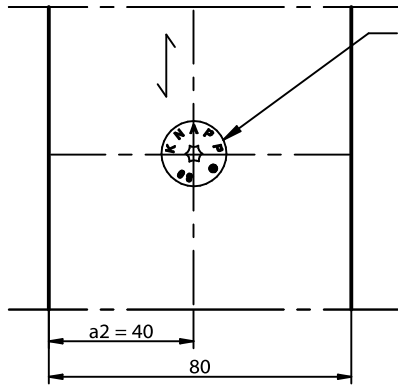
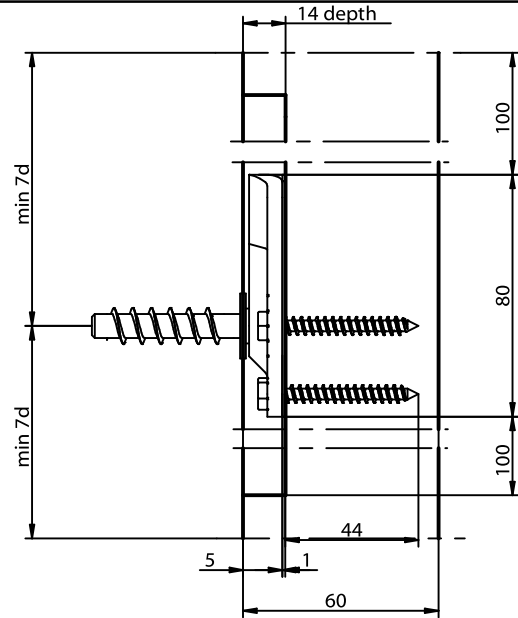
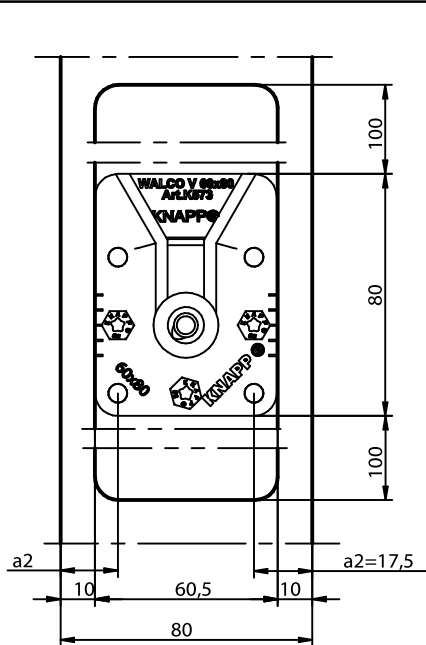

Collar screw 12x60 mm

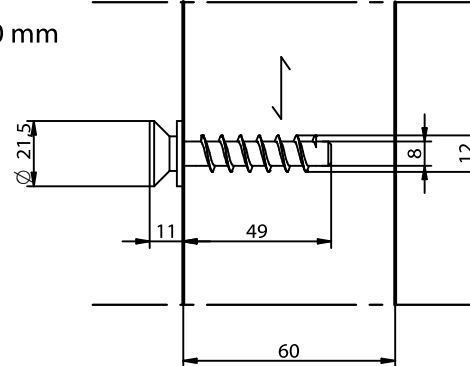

1. Positioning

2. Insertion

3. Locking

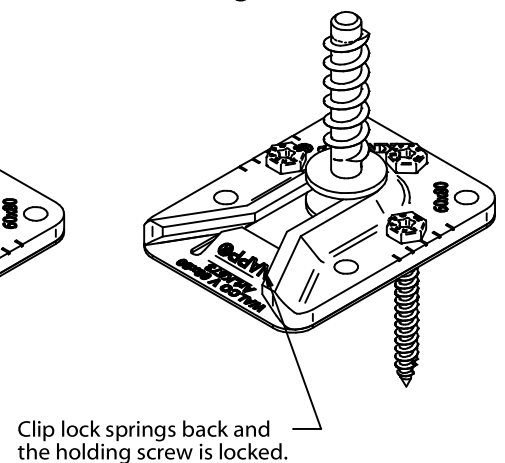
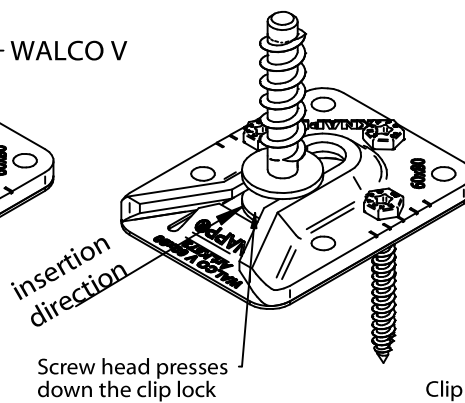
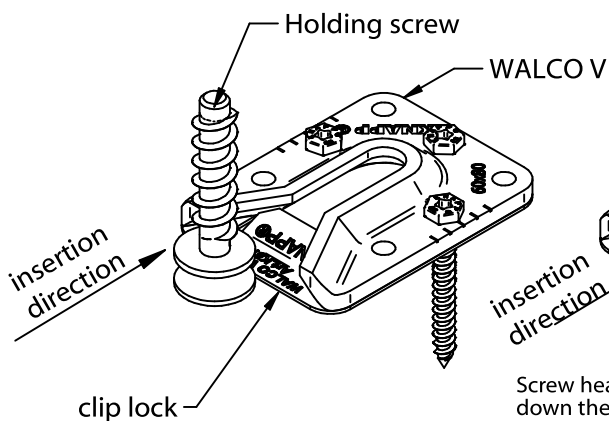

This drawing is the exclusive property of Knapp GmbH.

WALCO® V 60x80

Assemblage d'éléments muraux

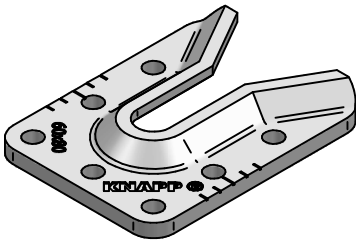

Vis à collerette 12x60
Réf. K102

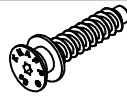

WALCO V 60x80
Ferrure d'accroche



1. Percer sur le montant opposé à la ferrure d'accroche et dans son axe (ou désaxé de 2-3 mm verticalement pour gagner en tolérance)

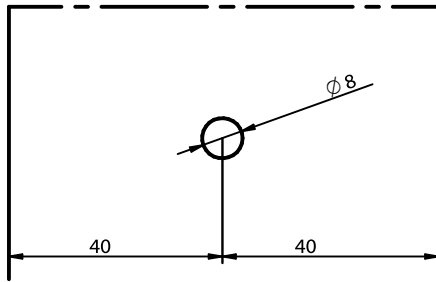

2. Visser la vis à collerette en butée

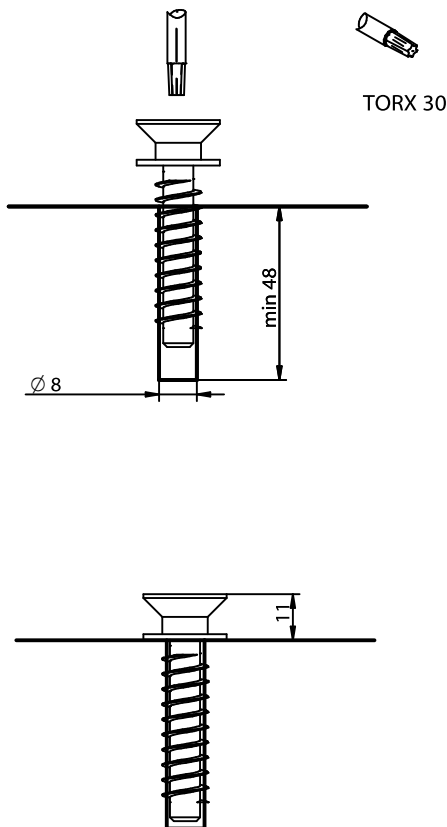

Note : une rondelle M12 peut être rajoutée dans le cas où un panneau de 15 mm d'épaisseur est utilisé à la place de l'encastrement sur le montant.

1. Usiner la poche d'encastrement de la ferrure d'accroche (env. 3 connecteurs par mur pour hauteur <3 m).

Dimensions de fraisage minimum (à la place d'un usinage, il est aussi possible de faire un rajout de matière de 13 ou 15 mm)

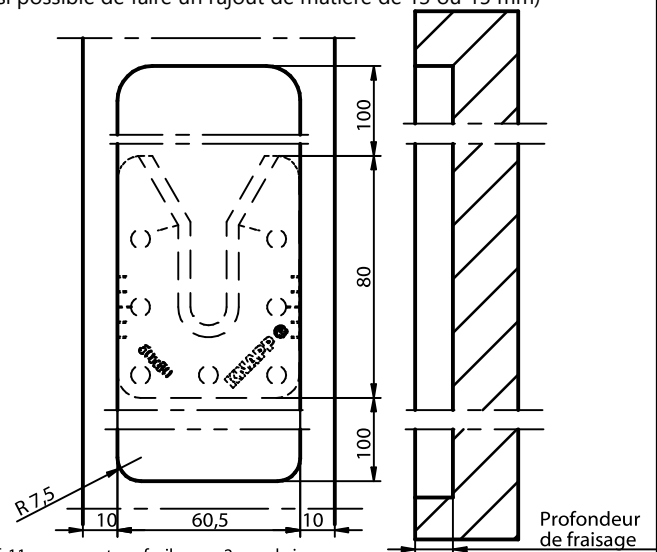

Prof. 11 mm - montage facile avec 2 mm de jeu
Prof. 13 mm - montage jointif sans jeu
Profondeur de fraisage avec insert et vis d'accroche: 11-22 mm
Profondeur de fraisage avec insert à ressort et vis d'accroche: 11-17 mm

2. Si besoin pointer les vis de fixation pour la ferrure et pré-percer

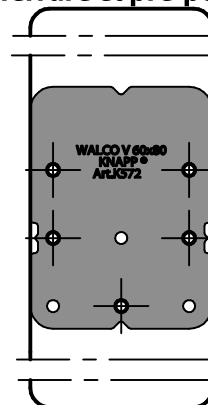

Ø 4 mm et prof. 50 mm
ou en alternative Ø 5 mm prof. 10 mm

Réf. K572

3. Visser la ferrure à son emplacement

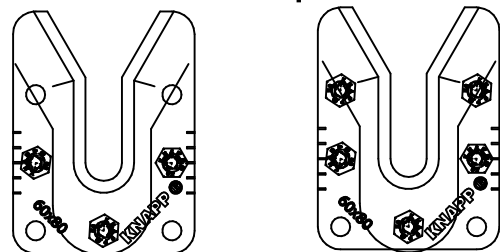

Standard:
3 vis à tête hexagonale 6x50 mm

Renforcé:
5 vis à tête hexagonale 6x50 mm

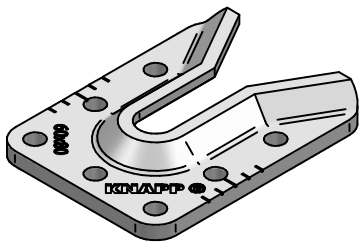

WALCO® V 60x80

Assemblage d'éléments muraux

Insert à ressort avec vis d'accroche M12 Réf. K106



1. Percer sur le montant opposé à la ferrure d'accroche et dans son axe

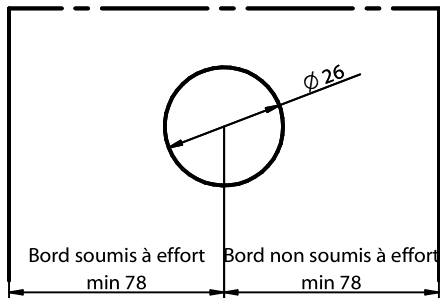

2. Visser l'insert avec l'outil de vissage

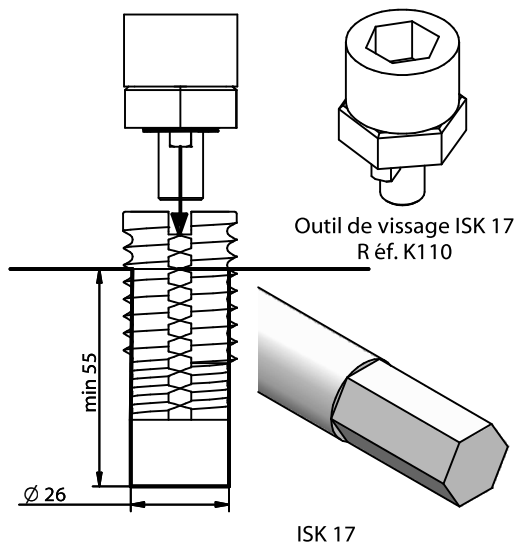

3. Visser la vis d'accroche

4. Régler la hauteur

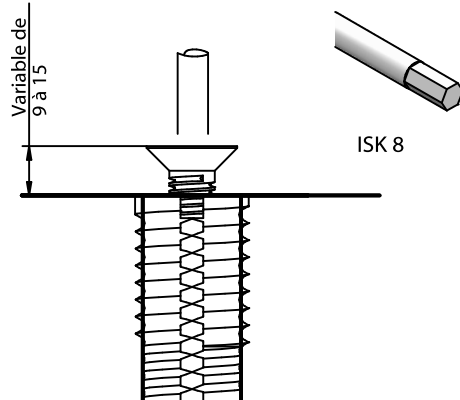

Insert avec vis d'accroche Réf. K104

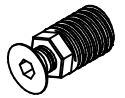

1. Percer sur le montant opposé à la ferrure d'accroche et dans son axe

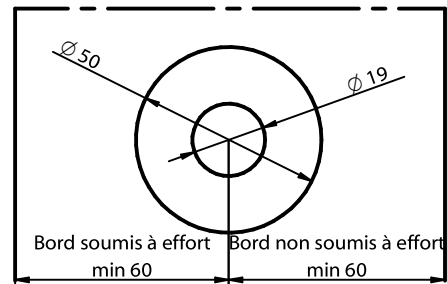

2. Visser l'insert

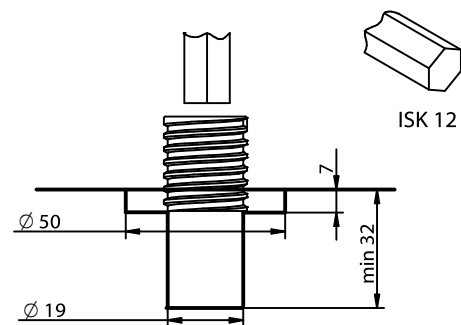

3. Visser la vis d'accroche avec l'écrou

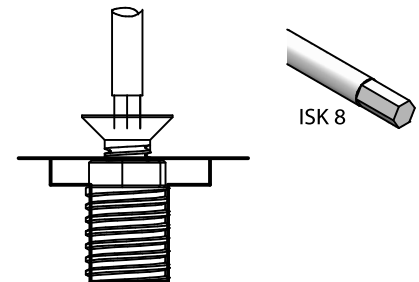

4. Régler la hauteur de vis et la serrer avec l'écrou

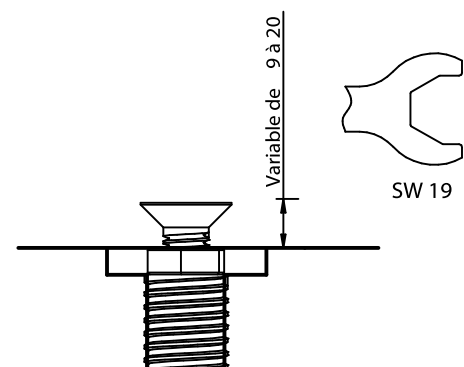

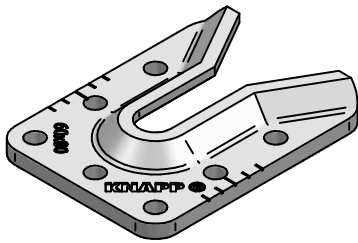

WALCO® V 60x80 VK D12

Assemblage d'éléments muraux

Pièce d'accroche vissée VK D12
Réf. K108



1. Percer sur le montant opposé à la ferrure d'accroche et dans son axe

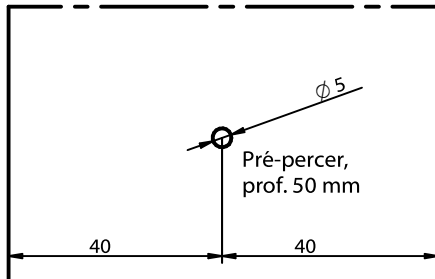

2. Visser la pièce d'accroche en butée

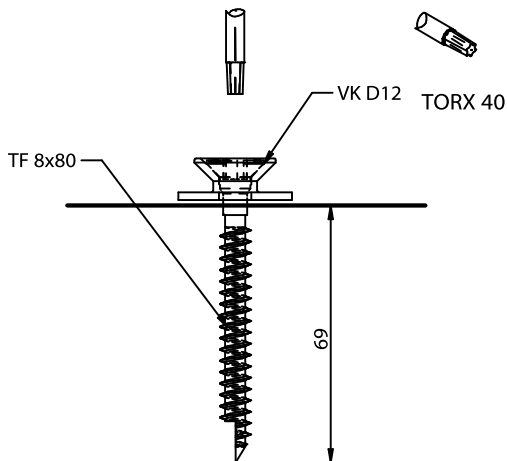

Note : une rondelle M12 peut être rajoutée dans le cas où un panneau de 15 mm d'épaisseur est utilisé à la place de l'encastrement sur le montant.

WALCO V 60x80 Ferrure d'accroche



1. Usiner la poche d'encastrement de la ferrure d'accroche (env. 3 connecteurs par mur pour hauteur <3 m).

Dimensions de fraisage minimum (à la place d'un usinage, il est aussi possible de faire un rajout de matière de 13 ou 15 mm)

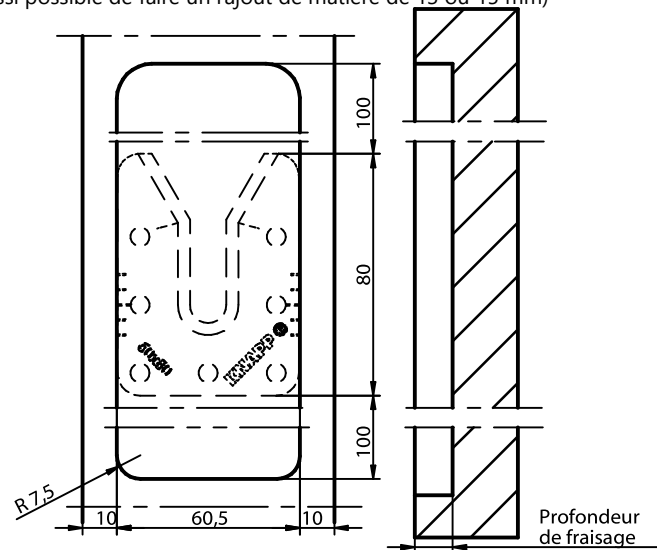

Prof. 11 mm - montage facile avec 2 mm de jeu
Prof. 13 mm - montage jointif sans jeu

2. Si besoin pointer les vis de fixation pour la ferrure et pré-percer

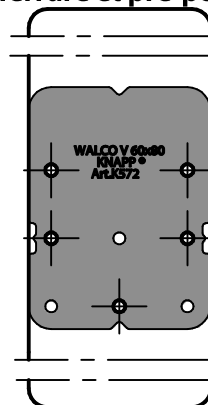

Ø 4 mm et prof. 50 mm
ou en alternative Ø 5 mm prof. 10 mm

Réf. K572

3. Visser la ferrure à son emplacement

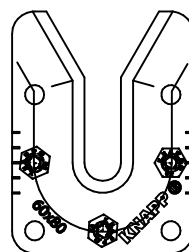

Standard:
3 vis à tête hexagonale 6x50 mm

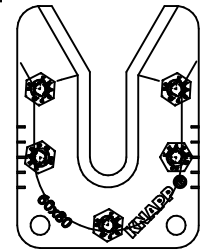

Renforcé:
5 vis à tête hexagonale 6x50 mm

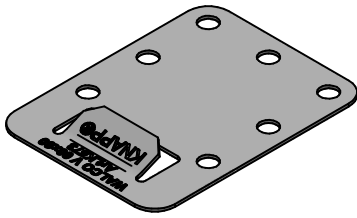

WALCO® V 60x80

Platine de verrouillage

Platine de verrouillage WALCO V60
Réf. K573

WALCO V 60x80

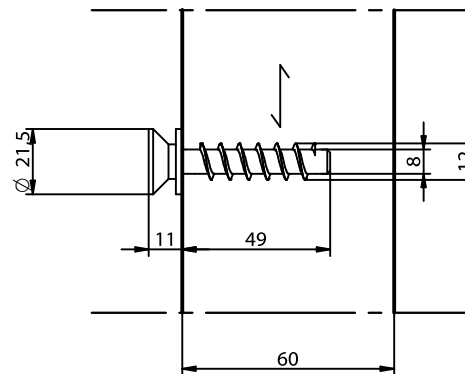
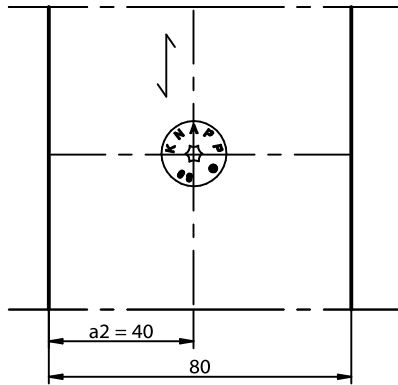
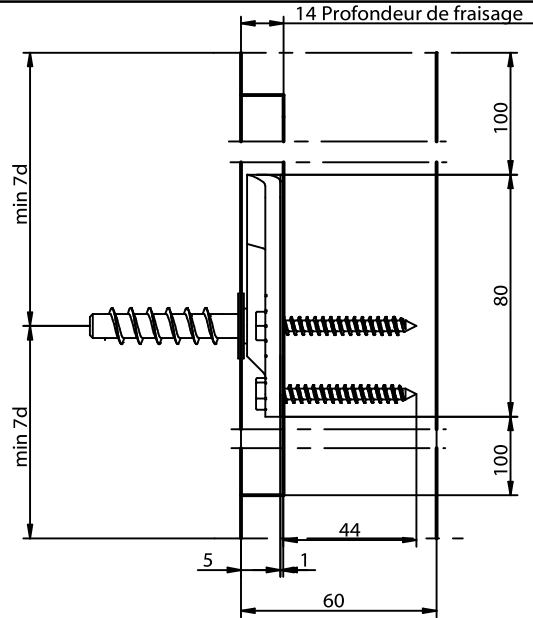
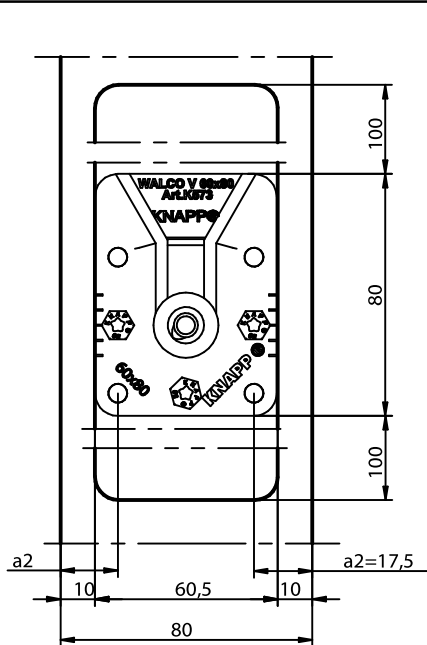

1. Mise en position

2. Emboîter

3. Verrouillage automatique

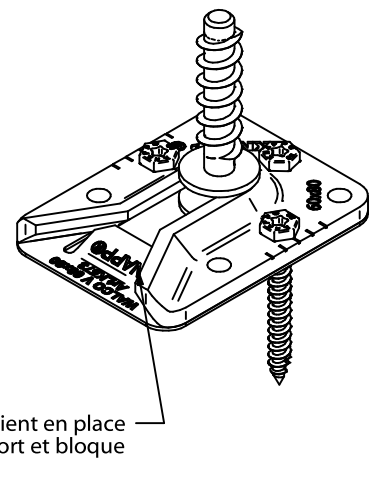
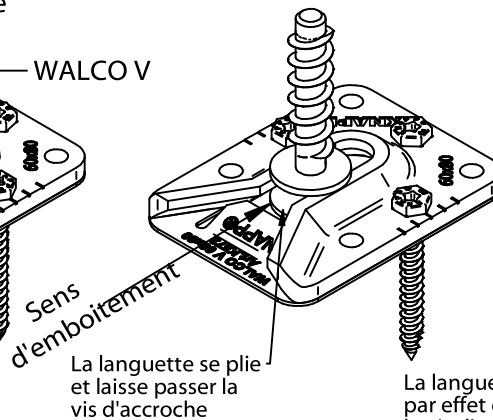
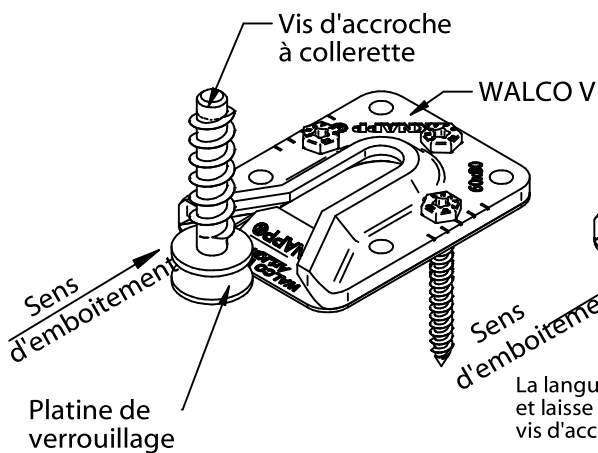

KNAPP®
connectors.com

Knapp GmbH ■ Wassergasse 31 ■ A-3324 Euratsfeld ■ Tel.: +43 (0)7474 / 799 10 ■ Fax: +43 (0)7474 / 799 10 99
Knapp GmbH ■ Vertrieb Deutschland ■ Föhrenweg 1 ■ D-85591 Vaterstetten ■ Tel.: +49 (0)8106 / 99 55 99 0 ■ Fax: +49 (0)8106 / 99 55 99 20 ■ E-Mail: info@knapp-verbinder.com
Knapp GmbH Sàrl ■ Filiale France ■ 1A Rue du Stade ■ F - 67880 Innenheim Tel. : +33 (0)3 88 48 17 87 ■ Fax: +33 (0)9 70 62 81 87 ■ E-Mail : france@knapp-connectors.com