

MODULAR

Cabinets and frames connectors

NEW



powered by
KNAPP®



KNAPP®
connectors.com

MODULAR Single clip

Made of spring steel for furniture construction and interior design

NEW

System benefits

- Quick assembly
- Completely concealed connectors for carcasses and frames
- Efficient and ideal for use in series production
- Components can be assembled in seconds
- Reduces labour and equipment costs
- High degree of prefabrication
- Perfect for industrial production with CNC
- Can be used with panel thickness from 16 mm



PRODUCT

Also available in other sizes!



1 MODULAR made of spring steel, hard to remove

2 Sturdy profile design for increased stress absorption

3 Hook-in eye with screw locking mechanism

4 Screw hole for easy installation

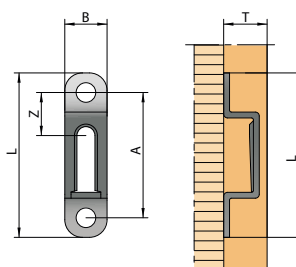
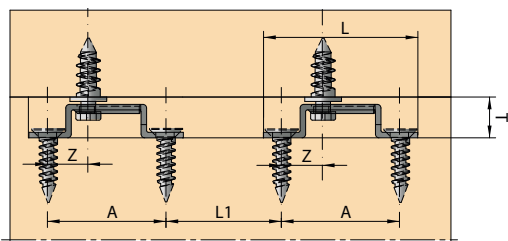

	MODULAR Serie	4031, 4032, 4035	5030, 5031, 5032, 5032/A
	Panel thickness from	16 mm	19 mm
A	Hole-line	32 mm	32 mm
B	Routing width	11 mm	13 mm
L	Routing length	42 mm	42 mm
T	Routing depth	11 mm	11 mm
Z	Center distance	11 mm	11 mm

Applications: Flat pack, RTA cabinets, case goods, and furniture.

Advantages: Concealed, self-tensioning sliding connector, fastenable in 32 mm increments, removable, can also be inserted into the clear dimension with the feed-through (item no. Z5030), can also be screwed onto metal profiles.

Suitable materials: For all solid wood, wood based panels and plastic materials from 16 mm thickness up.

Installation: Make groove with spindle moulder, plunge router, CNC equipment. Pre-drill with drill-jig, and install clips.

Mounting: With PH or SK screws up to Ø 4.5 mm (length as required) and corresponding shoulder head screws.

Accessories: Drilling and depth jig | Item no. K617 (M32/11), Item no. K618 (M44/11), Item no. K619 (M64/11)

Art.-No. Z5030

= MODULAR single clip 5030

Bolting grid 32 mm

pass-through



Art.-No. Z5032

= MODULAR single clip 5032

Fastenable in 32 mm increments

non-locking



Art.-No. Z5032/A

= MODULAR single clip 5032/A

Fastenable in 32 mm increments

semi-locking



Art.-No. Z5031

= MODULAR single clip 5031

Fastenable in 32 mm increments

locking



MODULAR Double clip

For even better resilience

System advantages

- Quick assembly
- Completely concealed for cabinets and frames
- Efficient and ideal for use in series production
- Components can be assembled in seconds
- Reduces labour and equipment costs
- High degree of prefabrication
- Perfect for industrial production with CNC
- Even better load-bearing capacity
- Optimised torsion resistance
- Can be used from 16 mm material thickness



PRODUCT

Also available
in other sizes!

Art.-No. Z5033

non-locking

= MODULAR Double clip 5033

Screw-fastenable in 64 mm increments



Art.-No. Z5035

semi-locking

= MODULAR Double clip 5035

Screw-fastenable in 64 mm increments



Art.-No. Z5034

locking

= MODULAR Double clip 5034

Screw-fastenable in 64 mm increments

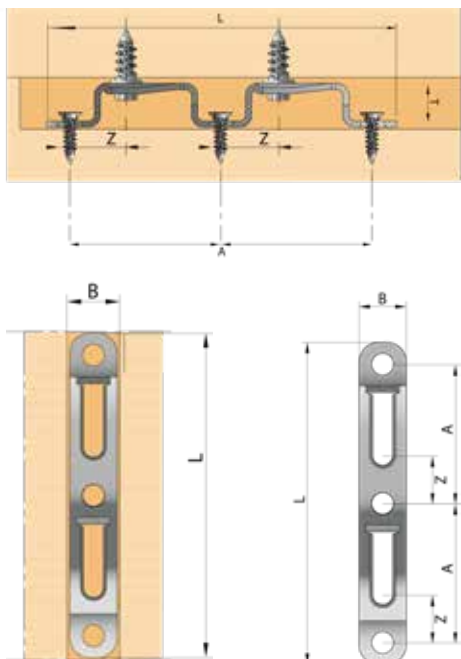

Furniture ready for series production
and packed in a space-saving manner.



The MODULAR connector enables the industrial production of furniture that can be packaged flat and compactly. This makes furniture easy to store, transport and deliver – clever, practical and economical.

Enables tool-free assembly.



Thanks to MODULAR, furniture can be assembled in no time at all – without any tools. The connectors enable simple, secure and quick assembly.

	MODULAR Serie	4036, 4037, 4038, 4039	5033, 5034, 4035
	Panel thickness from	16 mm	19 mm
A	Hole-line	32 mm	32 mm
B	Routing width	11 mm	13 mm
L	Routing length	74,5 mm	74,5 mm
T	Routing depth	11 mm	11 mm
Z	Center distance	11 mm	11 mm



MODULAR Anti-torsion

For twist-proof body or frame connections

100%
TORSION-PROOF!

System advantages

- Quick assembly
- Completely concealed for cabinets and frames
- Efficient and ideal for use in series production
- Components can be assembled in seconds
- Reduces labour and equipment costs
- High degree of prefabrication
- Perfect for industrial production with CNC
- Anti-torsion
- Can be used from 16 mm material thickness



Also available
in other sizes!

PRODUCT

Art.-No. Z5071 / Z5072

= MODULAR Anti-Torsion

pass-through

Screw-fastenable in 32 mm increments



Art.-No. Z5075 / Z5076

= MODULAR Anti-Torsion

w/ integrated stop

Screw-fastenable in 32 mm increments



Art.-No. Z5073 / Z5074

= MODULAR Anti-Torsion

locking

Screw-fastenable in 32 mm increments



Stable connections for self-assembly furniture

The two-part MODULAR anti-torsion clips are specially designed for ready-to-assemble (RTA) furniture and are used by cabinetmakers in interior design and the furniture industry. Two spring steel clips that fit together perfectly ensure a strong, torsion-resistant connection, ideal for carcass and frame construction, e.g. for chairs and tables.

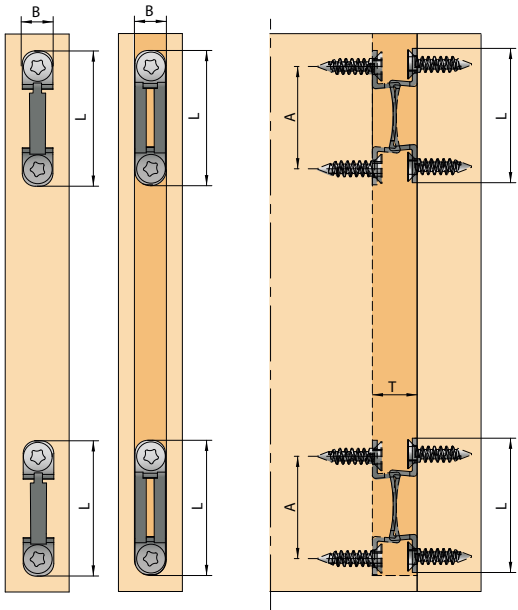
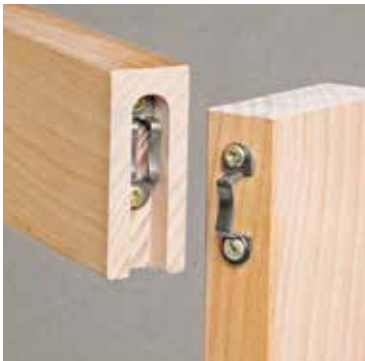

	MODULAR Serie	2075, 2076	5071, 5072, 5075, 5076
	Panel thickness from	16 mm	19 mm
A	Hole-line	32 mm	32 mm
B	Routing width	10 mm	13,5 mm
L	Routing length	42 mm	42 mm
T	Routing depth	14 mm	12 mm

Applications:	For twist-proof cabinet or frame joints.
Advantages:	Torsion-resistant, concealed, self-tensioning connector, screw-fastenable in 32 mm increments, removable.
Suitable materials:	All solid wood and plywood materials from 16 mm.
Installation:	With table router, CNC router, slot hole drilling machine, hand router.
Mounting:	With PH or SK screws up to Ø 5 mm (length as required).

Concealed | Self-tightening | Demountable

Installing MODULAR single clip with shoulder head screws



1 Mill the boards to the desired depth.



2 Check with the drilling and depth jig.



3 Position the drilling and depth jig.



4 Drill holes using the drilling guides.



5 Insert MODULAR.



6 Screw together.



7 Drill holes for shoulder head screws.



8 Screw in the shoulder head screws.



9 Hook up MODULAR.

Find all MODULAR products in our

Onlineshop!

- Quick assembly
- Self-tensioning
- Versatile
- Concealed connection

NEW



VIDEO



LOUIS, (FR) © Briag Courteaux

The perfect connector for efficient furniture series production!

- The components can be transported and easily assembled on site.
- Efficient and ideally suited for use in series production.
- The components can be easily assembled in seconds.
- The clips can be dismantled and reassembled.
- Reduces labour and equipment costs.
- Efficient: high degree of prefabrication.

Machine recommendation for all MODULAR products

All MODULAR connectors can be processed using a CNC machine from Gannomat, for example. This promises considerable time savings in the manufacture of the elements and their assembly.



PARTNER



Concealed | Self-tightening | Demountable

MODULAR screws and accessories

Suitable screws for all MODULAR connectors

Art.-No. Z513	MODULAR Mounting screw 513 PH Screw 25.4 mm (clip)	
Art.-No. Z1065	MODULAR 1065 Screw 12.7 mm	
Art.-No. Z1165	MODULAR 1165 Screw 15.9 mm	
Art.-No. Z2053	MODULAR 2053 Screw 10 mm	
Art.-No. Z2055	MODULAR 2055 Screw 13 mm	
Art.-No. Z2065	MODULAR 2065 Screw M4 12 mm	
Art.-No. Z2066	MODULAR 2066 Screw M4 16 mm	
Art.-No. Z2069	MODULAR 2069 Screw M4 15 mm	
Art.-No. Z2155	MODULAR 2155 Screw 16 mm	
Art.-No. Z5043	MODULAR 5043 Screw M5 9.53 mm	
Art.-No. Z5045	MODULAR 5045 Screw M5 11.12 mm	
Art.-No. Z5065	MODULAR 5065 Screw M5 15.9 mm	
Art.-No. Z5067	MODULAR 5067 Screw 11.12 mm	
Art.-No. Z5068	MODULAR 5068 Screw 32 mm	
Art.-No. Z5069	MODULAR 5069 Screw 6.4 mm	
Art.-No. Z5070	MODULAR 5070 Screw 22.23 mm	
Art.-No. Z5565	MODULAR 5565 Screw M5 13 mm	
Art.-No. Z5066	MODULAR 5565/5066 (double side connection) Screw M5 15 mm	
Art.-No. Z6043	MODULAR 6043 Screw 6.4 mm x 11.12 mm	
Art.-No. Z6065	MODULAR 6065 Screw 6.04 mm x 19.05 mm	
Art.-No. Z6066	MODULAR 6065/66 (double side connection) Screw 6.4 mm x 19.05 mm	
Art.-No. Z6068	MODULAR 6068 Screw 32 mm	
Art.-No. Z6069	MODULAR 6069 Screw 22.23 mm	
Art.-No. Z6165	MODULAR 6165 Screw 15.9 mm	



BOX

MODULAR Box 32mm hole centers

Art.-No. Z4031/B

125 pcs. MODULAR clips 4031 and 4032
250 pcs. MODULAR 2055 screws 13 mm
56 pcs. MODULAR 2069 screws M4 15 mm
56 pcs. MODULAR 2066 bushing screws M4 16 mm
1 depth gauge for groove Z4032C



MODULAR drilling and depth jig

Art.-No. K617 32 mm row hole spacing



MODULAR drilling and depth jig

Art.-No. K618 44 mm row hole spacing



MODULAR drilling and depth jig

Art.-No. K619 64 mm row hole spacing



Guiding symbols:



Assembly
3 or 4 sided



Concealed



Wood to wood
connection



Allow prefabrication
in workshop



No need for
clamping tool



MODULAR

Knapp GmbH | Wassergasse 31 | A-3324 Euratsfeld | Tel.: +43 (0)7474 / 799 10 | Fax: +43 (0)7474 / 799 10 99

Knapp GmbH | Vertrieb Deutschland | Föhrenweg 1 | D-85591 Vaterstetten
Tel.: +49 (0)8106 / 99 55 99 0 | E-Mail: info@knapp-verbinder.com | www.knapp-verbinder.com



YouTube



online-store

KNAPP®
connectors.com