

FIYU®

FAST 10

FAST 14

LOCK 14

Plug-in connector



patented by
KNAPP®

LOCK'N FAST!

Innovative - Clever - Connecting



KNAPP®
connectors.com

FIYU® FAST 10

Plug-in connector for cabinetry and interior fittings



Benefits:

- Flush-mounted, pre-assembled connector, stackable after pre-assembly
- Load bearing in three directions
- Self-locking
- Immediate stability and high load-bearing capacity
- Can be detachable and concealed
- No hook-in way required
- Precise guidance
- Manual and industrial processable possibilities
- High clamping force fits 100%

1 FIYU® FAST – Spring hook lamella

2 Fixing edge

3 Cutting edges

4 Guide pin

5 Spring hook

6 FIYU® FAST – Clamping lamella

7 Cutting edges

8 Spring hook receiver

9 Slots for guide pins

10 Tensioning screw (optional)



FIYU FAST

FIYU® FAST 10

Art.-No. K860

+ Optional tensioning screw M5x13 mm
| Art.-No. K857

NEW

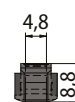
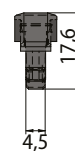
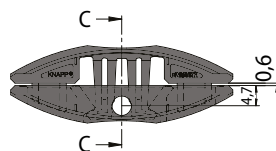
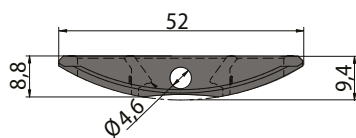
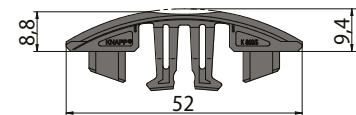

Cut C-C

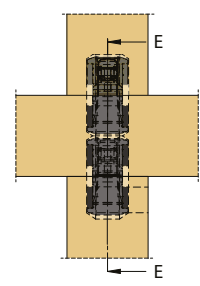
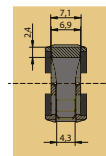

Cut E-E

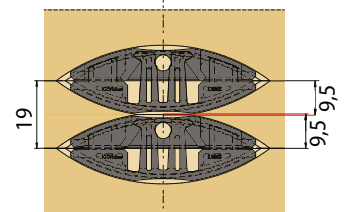

- From 12 mm material thickness
- For 10 mm milling depth

Installation



FIYU® FAST can be used as a centre panel shelf connector from 12 mm panel thickness onwards.



1 Insert facing each other into the pre-milled grooves.



2 Position the connector.



3 Plug the connectors element together.



4 Connecting components with or without adhesive.

FIYU® FAST 14

Plug-in connector for cabinetry and interior fittings

Benefits:

- Flush-mounted, pre-assembled connector, stackable after pre-assembly
- Load bearing in three directions
- Self-locking
- Immediate stability and high load-bearing capacity
- Can be detachable and concealed
- No hook-in way required
- Precise guidance
- Manual and industrial processable possibilities
- High clamping force fits 100%

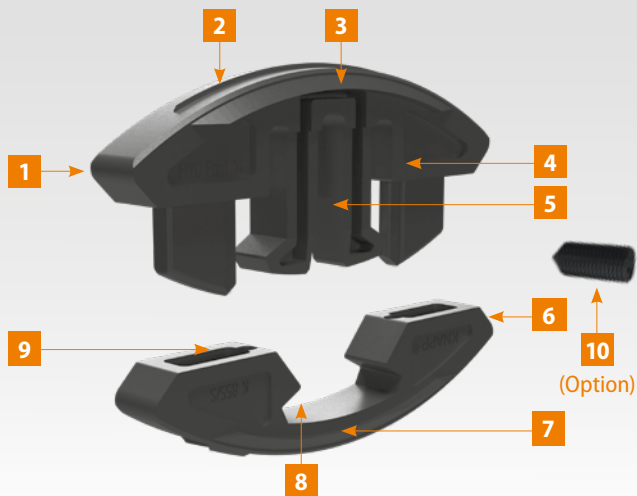

1 FIYU® FAST – Spring hook lamella

2 Fixing edge

3 Cutting edges

4 Guide pin

5 Spring hook

6 FIYU® FAST – Clamping lamella

7 Cutting edges

8 Spring hook receiver

9 Slots for guide pins

10 Tensioning screw (optional)



FIYU FAST

FIYU® FAST 14

Art.-No. K855

+ Optional tensioning screw M6x12 mm
| Art.-No. Z428

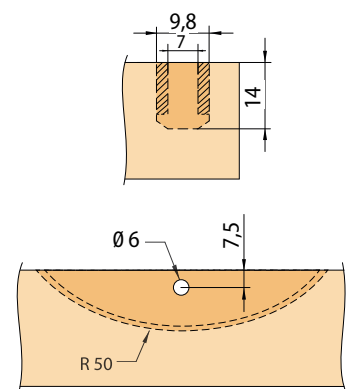
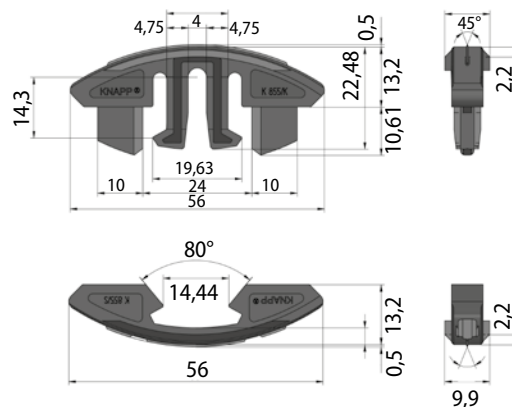

■ From 16 mm material thickness

■ For 14 mm milling depth

Installation



1 Secure butt joint (90°) with grub screw mitre at 45° with or without gluing plug together.



2 If required, lock with grub screw.
(can be dismantled and re-assembled again)



3 Mitred corner joint 45° (gluing aid).

FIYU® LOCK 14

Tongue and groove connector for cabinetry and interior fittings

Single or two-piece connector

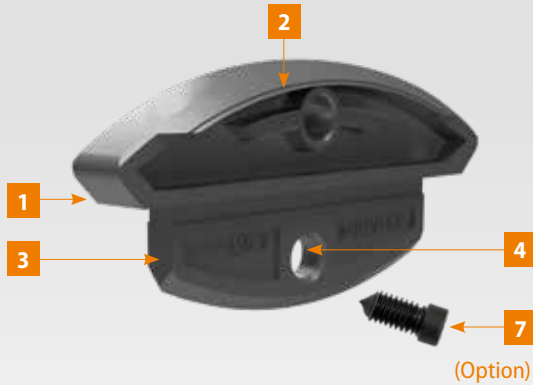

Benefits:

- Flexible installation sequence
- Mechanically lockable
- Immediate stability and high load-bearing capacity
- Can be detachable and concealed
- No hook-in way required
- Precise guidance
- Manual and industrial processable possibilities
- High clamping force fits 100%

- FIYU® LOCK – plug-in element
- Cutting edges
- Tongue (3,6 mm)
- Hole for tensioning screw
- Slotted recess for the tongue
- FIYU® LOCK – receiving element
- Tensioning screw M5x13 mm (optional)



FIYU® LOCK 14

Art.-No. K859

= FIYU® LOCK plug-in element + receiving element | Art.-No. K856/S + Art.-No. K856/A

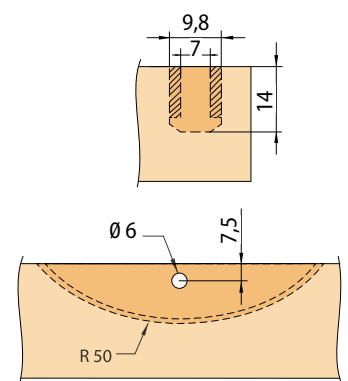
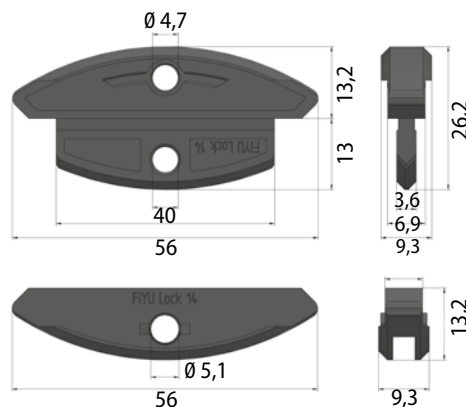

FIYU® LOCK 14 single

Art.-No. K856/S

= FIYU® LOCK receiving element | Art.-No. K856/S

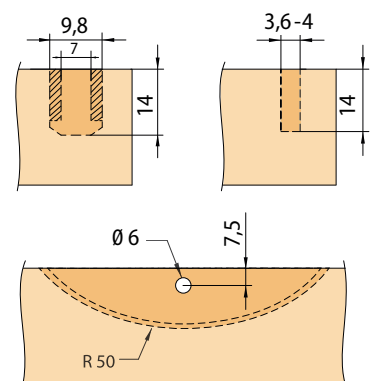
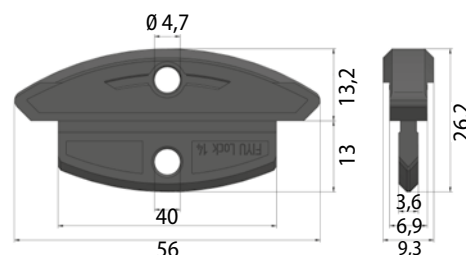
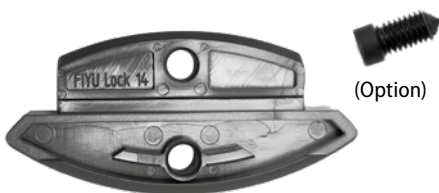

- From 16 mm material thickness
- For 14 mm milling depth

Concealed | Self-tightening | Demountable

Plug-in and tongue and groove connectors for cabinetry and interior fittings

Applications:	For cabinet parts and panels, claddings, covers and moldings, shelves and retrofitting of shelves as shelves supports.
Advantages:	Concealed, self-tightening, re-assemblable tongue and groove connector, immediately ready for use.
Suitable materials:	All wood, and plastic materials (FIYU® LOCK 14), from 16 mm thickness. All wood, and board materials (FIYU® FAST 10), from 12 mm thickness.
Fabrication:	With CNC, flat dowel machine, adjust depth setting accurately.
Assembly:	Insert plug-in part and holding part into milled groove, then clip the components together.
Accessories:	Tensioning screw FIYU® 6×12 mm (for FIYU® FAST 14) Art.-No. Z428, Tensioning screw M5×13 mm (for FIYU® LOCK 14 and FIYU® FAST 10) Art.-No. K857, Allen key with ball end Art.-No. Z647

FIYU® FAST 10 + FIYU® FAST 14 assembly example



Connector for plugging
90° mitre joints.



Connector for plugging
45° mitre joints

Pre-assemble, plug in, done: the FIYU® FAST (sizes 10 and 14) creates concealed, strong joints for panels, cladding, covers and cabinet components. With an angle range of **0 to 135°** and mitres **from 45°**, it is ideal for fast, precise and aesthetic installations.

Spread thin: the new FIYU® FAST 10 variant effortlessly joins thin **material thicknesses from 12 mm**. Also perfect for right-angled installation of centre walls **from 18 mm** panel thickness without the connector halves touching. For detailed precision and demanding applications.

FIYU® LOCK assembly example



Corner connections
such as window frames

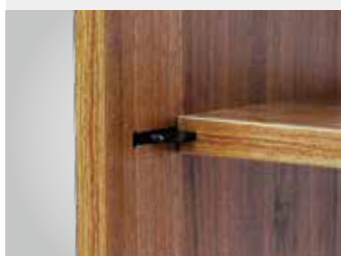

Retrofitting
shelves (example)

Two-piece connector, for more flexibility: FIYU® LOCK 14 holds cabinet parts together, shelves and more at angles **from 0 to 135°**. Fixed with a screw, the tongue and groove connector creates a demountable connection. Applying glue makes the connection permanent.

Or one-piece, for faster installation: the FIYU® LOCK single is inserted into the pre-milled groove. With an optional clamping screw, it becomes a practical shelf support or guide aid, ideal for retrofitting shelves or for more flexible assembly of cabinets. A simple drill hole in the component is all that is required.



Machines recommendation for FIYU® Products

All FIYU® connectors can be processed on a CNC machine.
This results in considerable time savings in the production and assembly of the elements.
A flat dowel milling machine can also be used for special on-site adaptations.

Plug-in connectors in plastic

Art.-No. K060

FIYU® FAST 10

for 10 mm groove

NEW



Size 10

- Concealed, self-tightening, removable connector, immediately usable.
- For cabinets, intermediate shelves and the subsequent installation of shelves as shelf supports and for panels from 12 mm upwards.
- Fastening by radial insertion, with cutting edges on both sides.

Plug-in connectors in plastic

Art.-No. K856

FIYU® LOCK 14 – single

for 14 mm groove

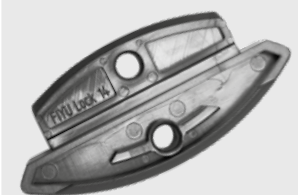

Size 14

- Concealed, self-tightening, removable connector, immediately usable.
- For cabinets, intermediate shelves and the retrofitting of shelves as shelf supports and for panels.
- Fastening by radial insertion, with cutting edges on both sides.

Plug-in connectors in plastic

Art.-No. K855

FIYU® FAST 14

for 14 mm groove

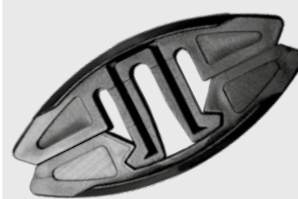

Size 14

- Concealed, self-tightening, removable connector, immediately usable.
- For cabinets and the retrofitting of shelves as shelf supports and for panels.
- Fastening by radial insertion, with cutting edges on both sides.

Plug-in connectors in plastic

Art.-No. K859

FIYU® LOCK 14 – zweiteilig

for 14 mm groove



Size 14

- Concealed, self-tightening, removable connector, immediately usable.
- For cabinets, intermediate shelves and the retrofitting of shelves as shelf supports and for panels.
- Fastening by radial insertion, with cutting edges on both sides.

Further connector recommendations for furniture construction can be found at www.knapp-connectors.com/en:

Clip-in biscuit connector, plastic

Art.-No. K058

FAST 20

for 4 mm groove



Size 20

- Concealed, self-tensioning, removable connector, immediately loadable.
- For panels, panelling, covers and profile strips to clip on.
- Fastening by radial hammering with cutting edges on both sides and optional gluing.

Slide-in biscuit connector, alloy-diecast

Art.-No. K026

METAL

for 4 mm groove

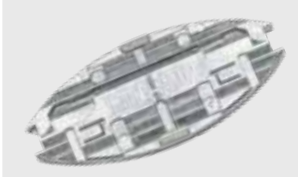

Size 20

- Concealed, self-tightening, detachable connector with integrated stop for locking.
- For cabinet furniture and door panelling for insertion without clamps, for mitre cuts.
- Fastening by screwing with PH screws.

Slide-in biscuit connector, alloy-diecast

Art.-No. K049

SILVER

for 4 mm groove



Size 20

- Concealed, self-tightening, removable connector with integrated stop stop for locking, can be loaded immediately.
- For cabinet furniture, gluing aid for mitres and corners without clamps.
- Fastening by radial hammering with cutting edges on both sides.

Slide-in biscuit connector, glass fiber reinforced plastic

Art.-No. K023

CHAMP

for 4 mm groove



Size 20

- Concealed, self-tightening, reassemblable connector..
- For cabinet furniture, gluing of mitres and corners without mitres and corners without clamps.
- Fastening by gluing with KNAPP®-KLEBER PU+.

Slide-in biscuit connector, plastic

Art.-No. K053

SUNNY

for 4 mm groove



Size 20

- Concealed, self-tightening connector with automatic locking by means of locking tabs, can be loaded immediately.
- For cabinet furniture, gluing aid for mitres and corners mitres and corners without clamps.
- Fastening by radial hammering with cutting edges on both sides.

Symbols:



Wood to wood connection



Vertical assembly



Concealed



Enabling prefabrication in workshop



Flush installation



Clamp-free

DOWNLOADS

NEWSLETTER



WEBSITE



YouTube



online-store