

Art.-Nr.

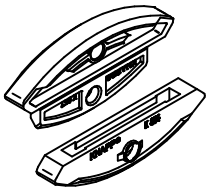

Montageanleitung FIYU® LOCK 14

Korpusverbinder

Art.-Nr. K856/S, K856/A

FIYU® LOCK 14 Steckteil (Art.-Nr. K856/S)

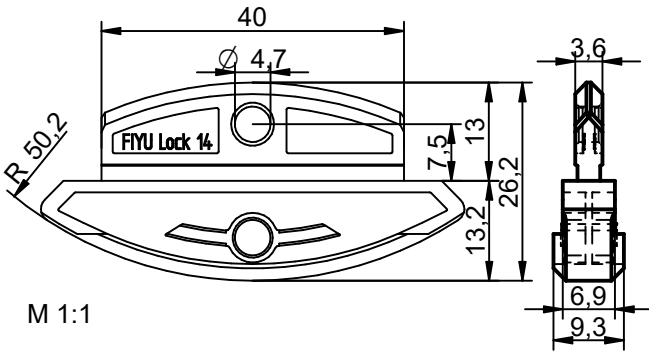

M 1:1

1. Fräsen

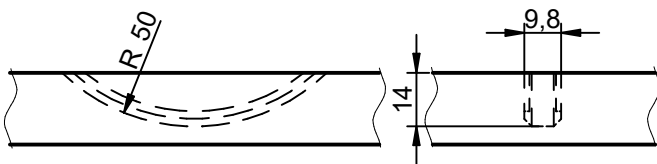

2. Einsetzen

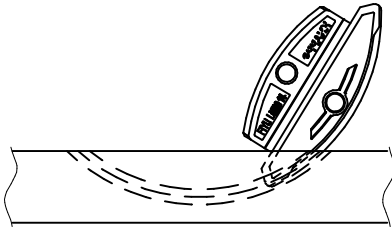

M 1:2

3. Bauteile zusammen stecken

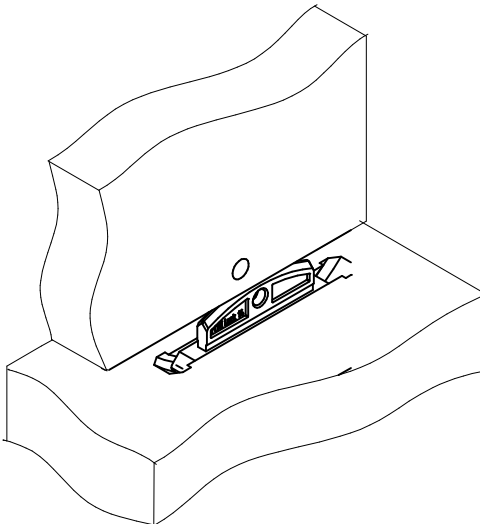

FIYU® LOCK 14 Aufnahmeteil (Art.-Nr. K856/A)

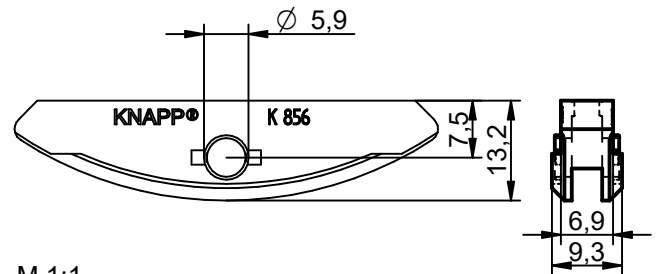

M 1:1

1. Fräsen und Bohren

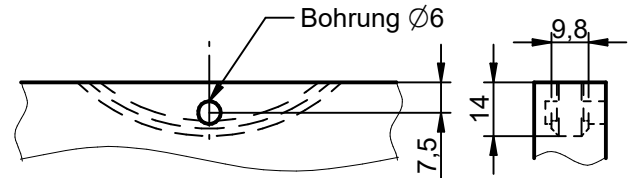

2. Einsetzen

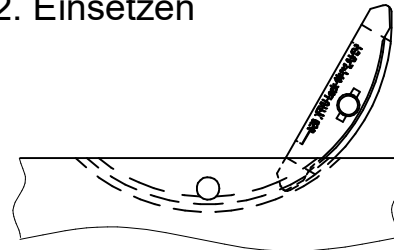

M 1:2

4. Spannschraube eindrehen

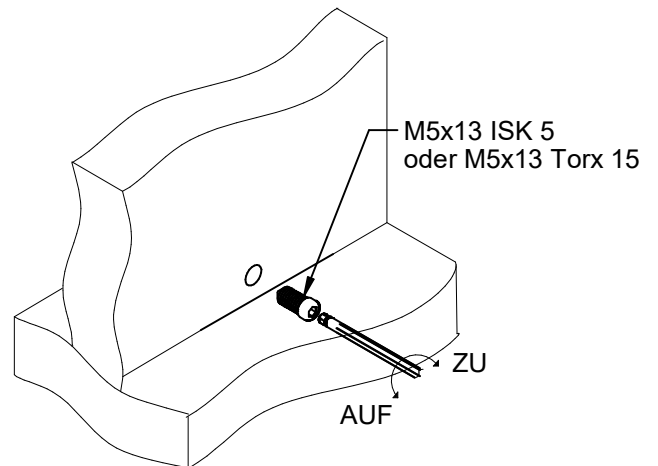

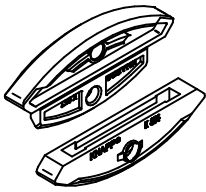

Assembly Instructions

FIYU® LOCK 14

Cabinet connector

Art.-No. K856/S, K856/A

FIYU® LOCK 14 plug-in part (Art.-No. K856/S)

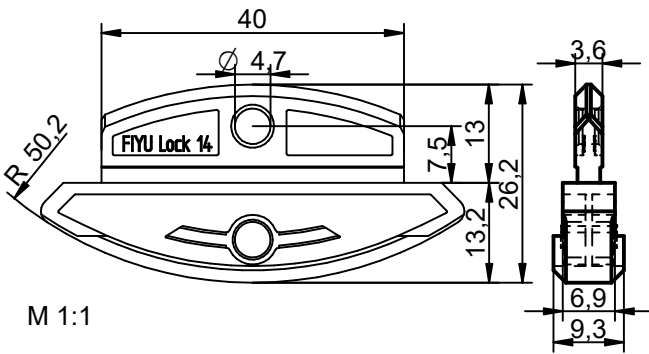

1. Milling

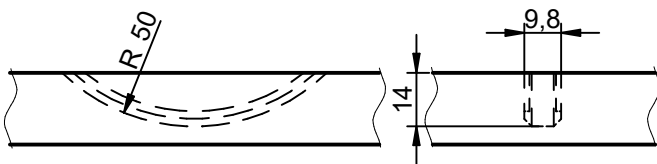

2. Insert

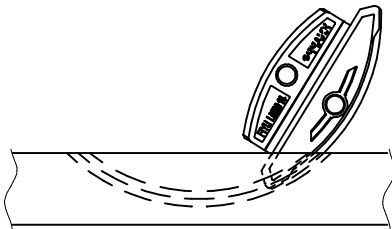

M 1:2

3. Put the components together

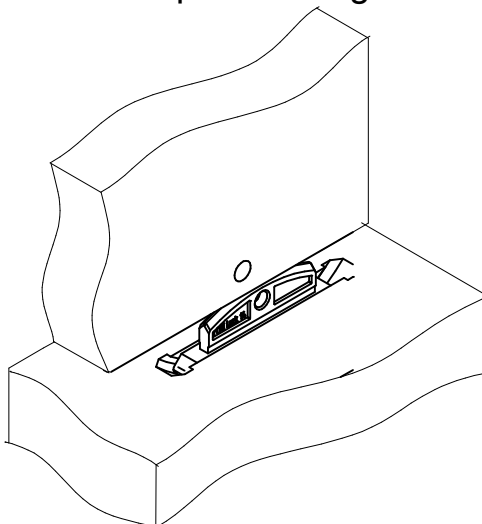

FIYU® LOCK 14 holding part (Art.-Nr. K856/A)

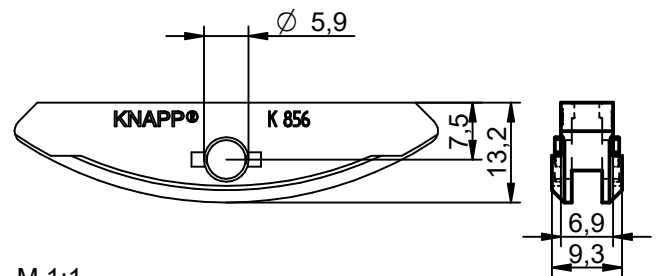

1. Milling and Drilling

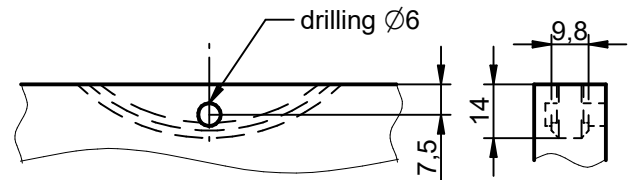

2. Insert

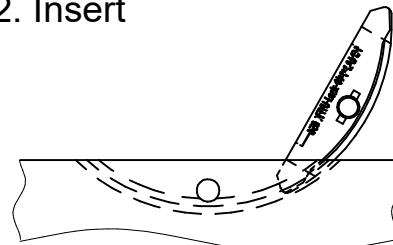

M 1:2

4. Screw in the clamping screw

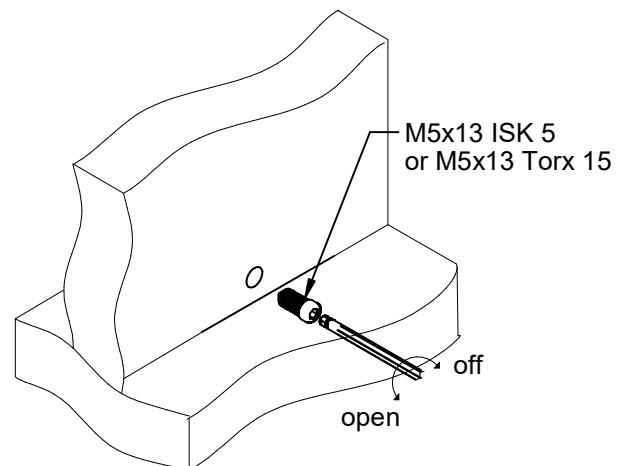

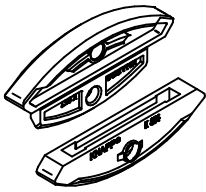

FIYU® LOCK 14

Assembleur corps de meuble

Réf. K856/S, K856/A

FIYU® LOCK 14 - pièce mâle
(Réf. K856/S)

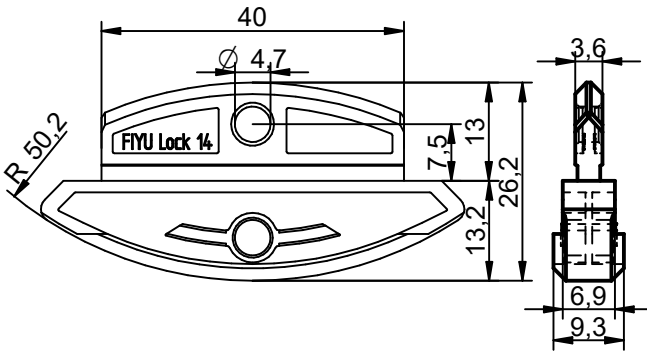

1. Fraiser

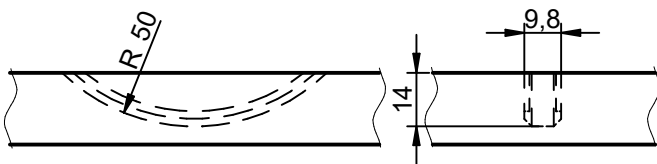

2. Insérer

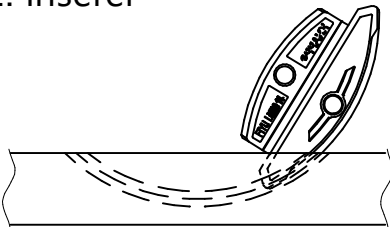

3. Emboîter les éléments

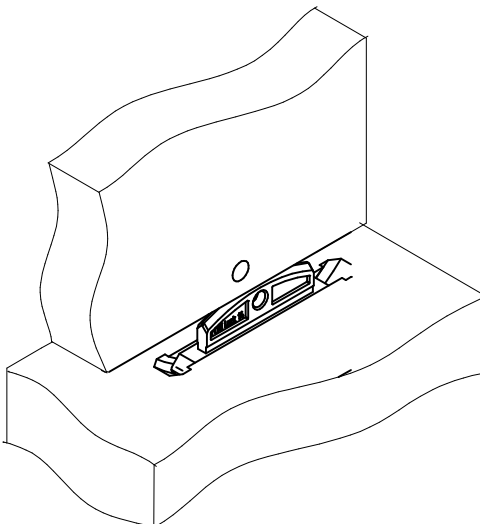

FIYU® LOCK 14 - pièce femelle
(Réf. K856/A)

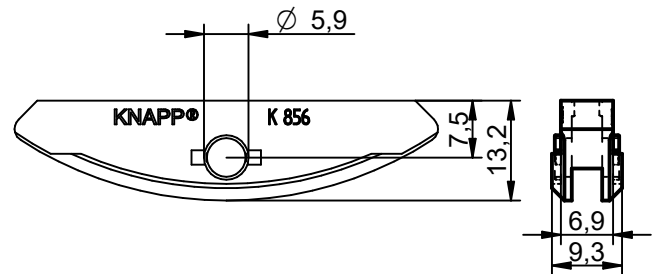

1. Fraiser et percer

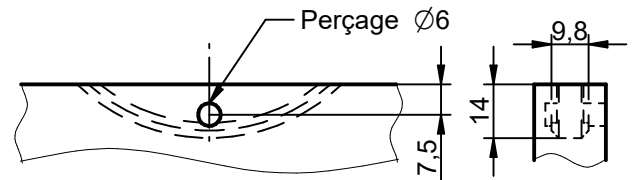

2. Insérer

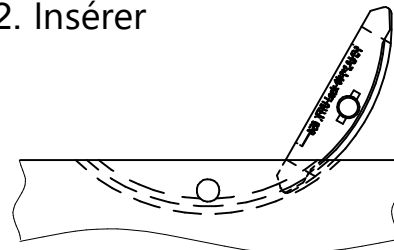

4. Visser la vis de serrage

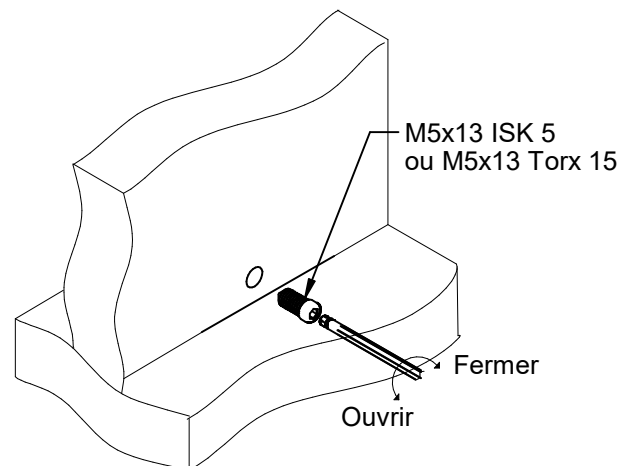

KNAPP®
connectors.com

Knapp GmbH ■ Wassergasse 31 ■ A-3324 Euratsfeld ■ Tel.: +43 (0)7474 / 799 10 ■ Fax: +43 (0)7474 / 799 10 99
Knapp GmbH ■ Vertrieb Deutschland ■ Föhrenweg 1 ■ D-85591 Vaterstetten ■ Tel.: +49 (0)8106 / 99 55 99 0 ■ Fax: +49 (0)8106 / 99 55 99 20 ■ E-Mail: info@knapp-verbinder.com
Knapp GmbH Sàrl ■ Filiale France ■ 1A Rue du Stade ■ F - 67880 Innenheim Tel. : +33 (0)3 88 48 17 87 ■ Fax: +33 (0)9 70 62 81 87 ■ E-Mail : france@knapp-connectors.com