

# RICON® 60/40



ETA-10/0189

**Pfosten-Riegelverbindung**  
mit Bauzulassung (DE+EU)  
**post and latch connection**

with construction supervisory approval (DE+EU)

<p>RICON® 60/40</p>	<p>RICON® SK Scr 8x80</p> <p>RICON® SK Scr 8x50</p> <p>RICON® SK Scr 5x80</p> <p>RICON® SK Scr 5x50</p> <p>RICON® Sperrbügel / stirrup</p>	<p>RICON ISK M 8x25, M8x20</p> <p>RICON® ISK M5x20</p> <p>Verbundmutter / connecting nut M8x48, 53, 58, 78 M5x48, 53, 58, 78</p> <p>RICON® Einschraubmutter / insert M8x18</p> <p>RICON® Einschraubmutter / insert M5x14</p>
---------------------	--	--

**Einzel und Doppelanschluss**  
**single and double connection**

**Pfosten-Riegelverbindung**  
**latch and post connection**

Riegel Fräsbild /  
Milled edge latch

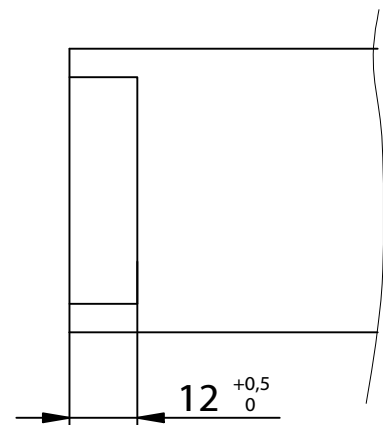
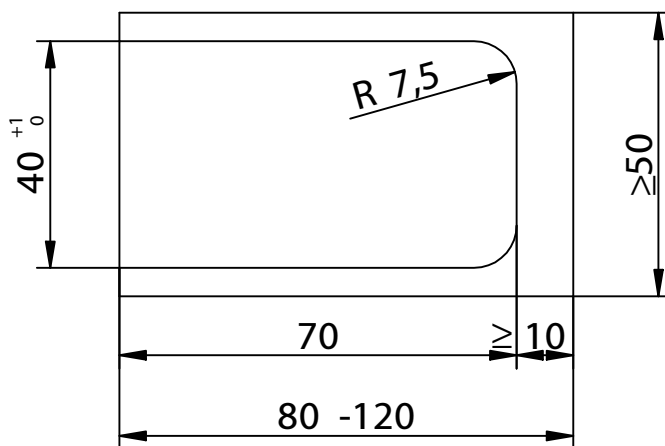

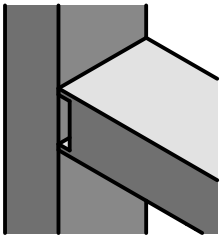

# Montageanleitung/Construction Manual

## RICON® 60/40 EA

Art. Nr. K360

**Einzelanschluss  
single connection**

**Pfosten-Riegelverbindung  
latch and post connection**

Bohrbild im Riegel /  
drilling template for latch

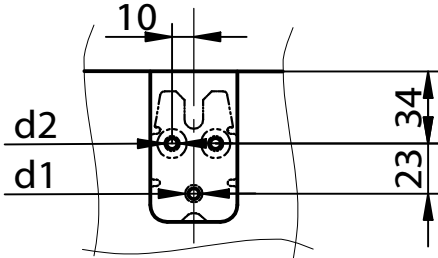

d1...Ø 5mm, 30mm tief vorbohren  
d1...Ø 5mm, 30mm deep predrilling

d2...Ø 5mm, 10mm tief vorbohren im Nadelholz  
d2...Ø 3,5mm, 50mm tief vorbohren im Laubholz  
d2...Ø 5mm, 10mm deep predrilling in softwood  
d2...Ø 3,5mm, 50mm deep predrilling in hardwood

Bohrbild im Pfosten /  
drilling template for post

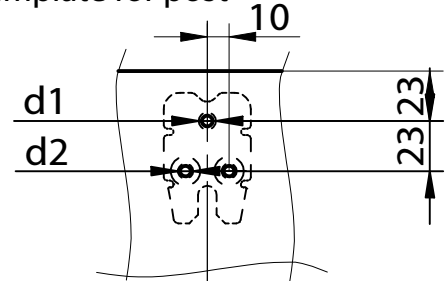

d1...Ø 5mm, 30mm tief vorbohren  
d1...Ø 5mm, 30mm deep predrilling

d2...Ø 5mm, 10mm tief vorbohren im Nadelholz  
d2...Ø 3,5mm, 30mm tief vorbohren im Laubholz  
d2...Ø 5mm, 10mm deep predrilling in softwood  
d2...Ø 3,5mm, 30mm deep predrilling in hardwood

Schraubenbild im Riegel /  
screw template for latch

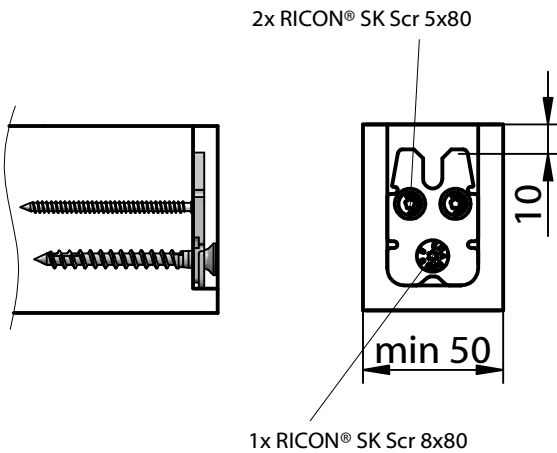

Schraubenbild im Pfosten /  
screw template for post

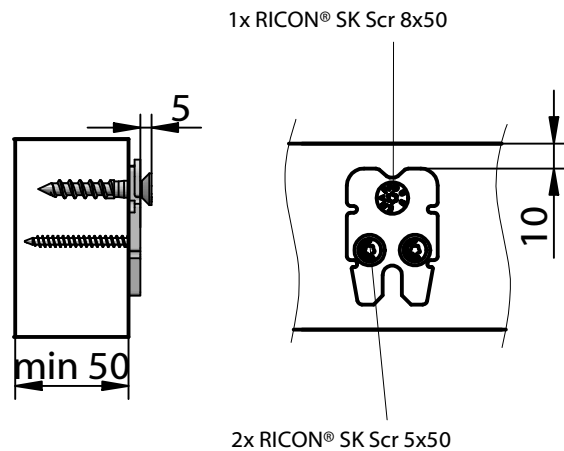

Einstellen der Schraube /  
screw position adjustment

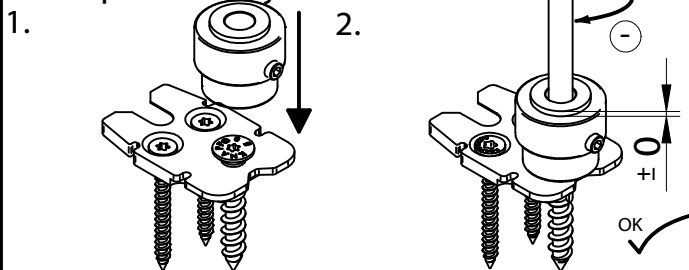

Sperrbügel einlegen /  
assemble stirrup

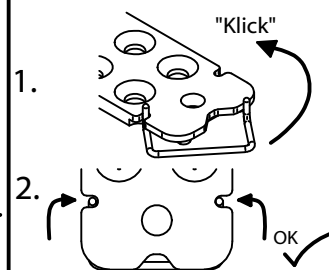

Sperrbügel lösen /  
remove stirrup

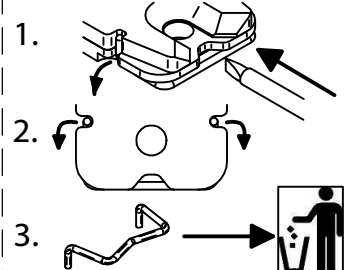

Diese Zeichnung ist Eigentum der Knapp GmbH.

© Knapp GmbH - Alle Maße in mm - Irrtümer, Druckfehler und Änderungen vorbehalten. VERSION 06.11.2013

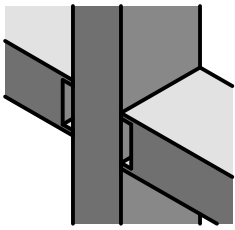

## RICON® 60/40 DA

Art. Nr. K160/48;  
K160/58; K160/78

**Doppelanschluss**  
**double connection**

**Pfosten-Riegelverbindung**  
**latch and post connection**

Bohrbild im Riegel /  
drilling template for latch

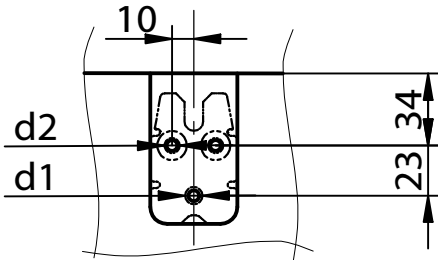

d1...Ø 5mm, 30mm tief vorbohren  
d1...Ø 5mm, 30mm deep predrilling

d2...Ø 5mm, 10mm tief vorbohren im Nadelholz  
d2...Ø 3,5mm, 50mm tief vorbohren im Laubholz  
d2...Ø 5mm, 10mm deep predrilling in softwood  
d2...Ø 3,5mm, 50mm deep predrilling in hardwood

Bohrbild im Pfosten /  
drilling template for post

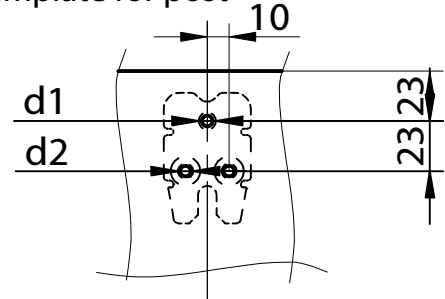

d1...Ø 10mm, Durchgangsloch  
d1...Ø 10mm, throughhole

d2...Ø 8mm, Durchgangsloch  
d2...Ø 8mm, throughhole

Schraubenbild im Riegel /  
screw template for latch

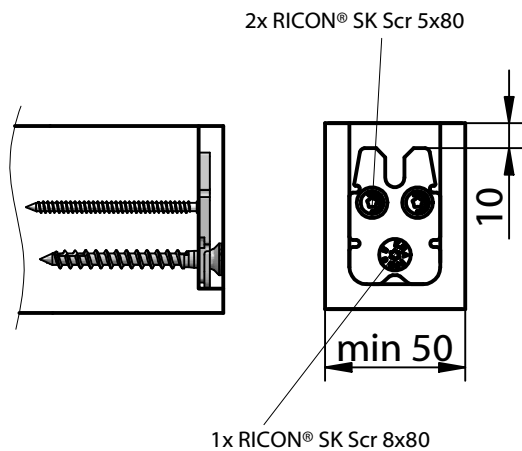

Schraubenbild im Pfosten /  
screw template for post

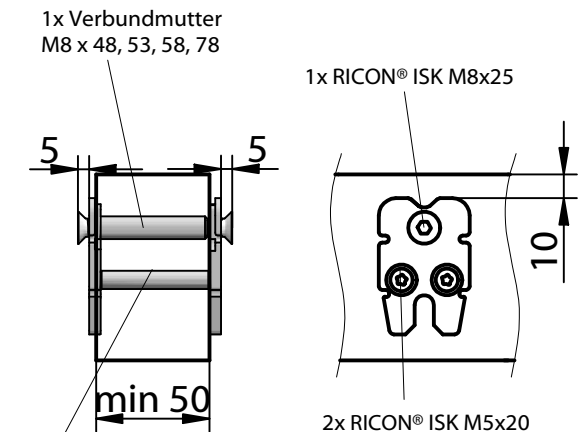

Pfosten- stärke [mm]	Verbund- mutterlänge [mm]
50	48
56	53
60	58
80	78

Einstellen der Schraube /  
screw position adjustment

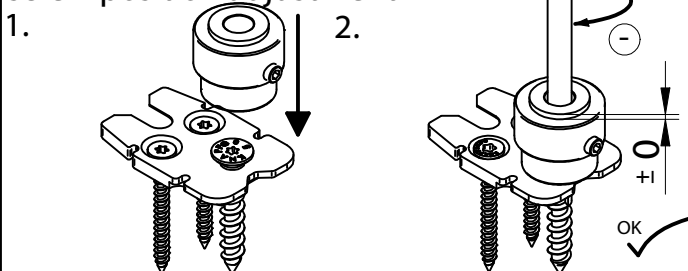

Sperrbügel einlegen /  
assemble stirrup

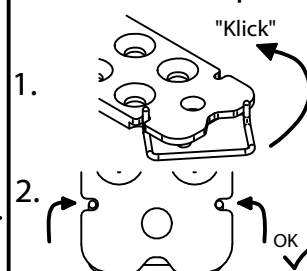

Sperrbügel lösen /  
remove stirrup

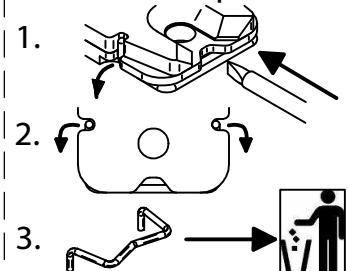

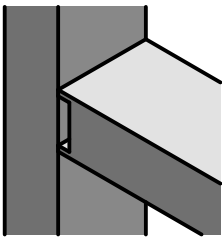

# Montageanleitung/Construction Manual

# RICON® 60/40 EAR

Art. Nr. K260 Einzelanschluss mit Einschraubmutter  
single connection with insert screw

Pfosten-Riegelverbindung  
post and latch connection

Bohrbild im Riegel /  
drilling template for latch

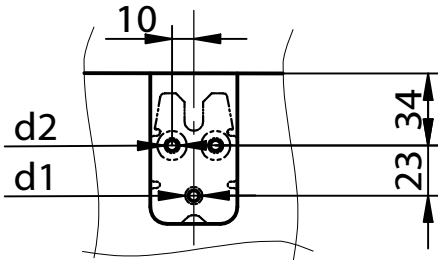

d1...Ø 5mm, 30mm tief vorbohren  
d1...Ø 5mm, 30mm deep predrilling

d2...Ø 5mm, 10mm tief vorbohren im Nadelholz  
d2...Ø 3,5mm, 50mm tief vorbohren im Laubholz  
d2...Ø 5mm, 10mm deep predrilling in softwood  
d2...Ø 3,5mm, 50mm deep predrilling in hardwood

Bohrbild im Pfosten /  
drilling template for post

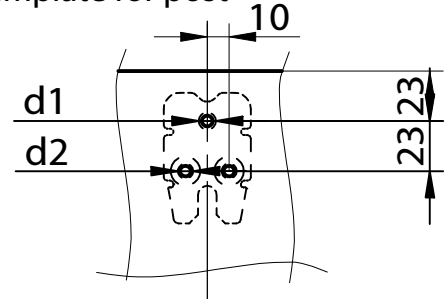

d1...Ø 12 mm, 20 mm tief vorbohren  
d1...Ø 12 mm, 20 mm deep predrilling

d2...Ø 8 mm, 15 mm tief vorbohren  
d2...Ø 8 mm, 15 mm deep predrilling

Schraubenbild im Riegel /  
screw template for latch

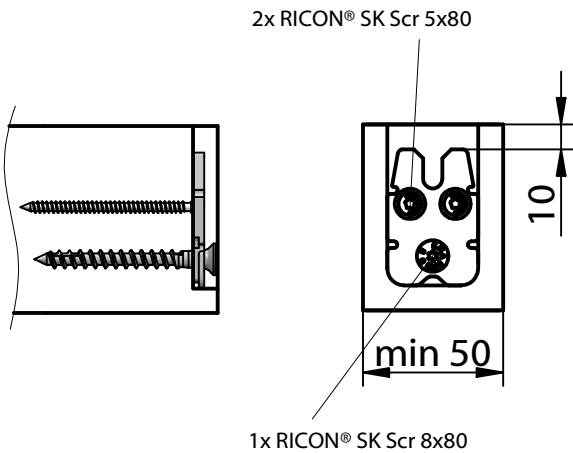

Schraubenbild im Pfosten /  
screw template for post

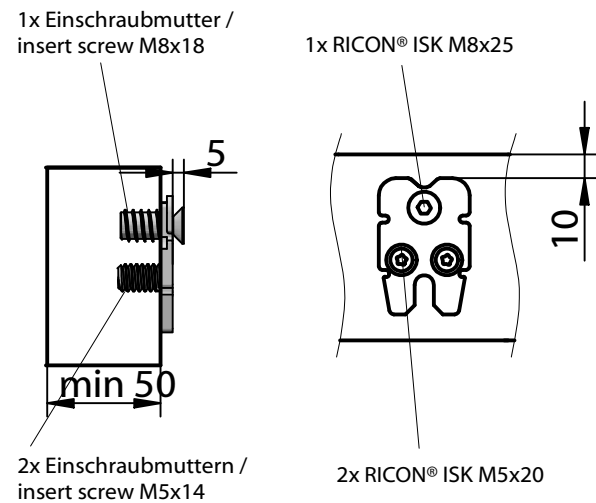

Einstellen der Schraube /  
screw position adjustment

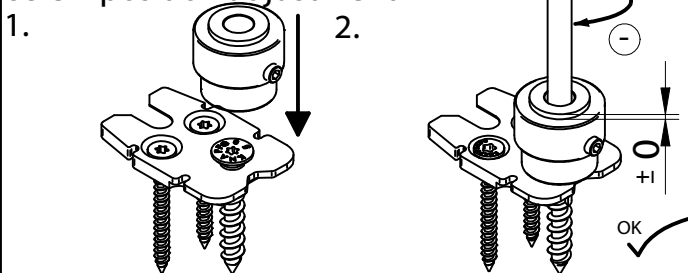

Sperrbügel einlegen /  
assemble stirrup

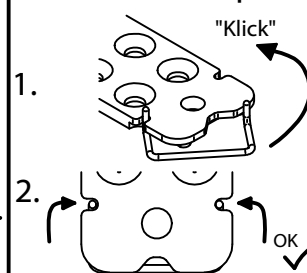

Sperrbügel lösen /  
remove stirrup

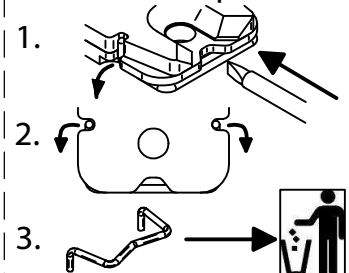

Diese Zeichnung ist Eigentum der Knapp GmbH.

© Knapp GmbH - Alle Maße in mm - Irrtümer, Druckfehler und Änderungen vorbehalten. VERSION 06.11.2013

# RICON® 60/40



ETA-10/0189

**Haupt- Nebenträgerverbindung**  
mit Bauzulassung (DE + EU)

**main girder- joist connection -**  
with construction supervisory approval (DE + EU)

<p>RICON® 60/40</p>	<p>RICON® SK Scr 8x80</p> <p>RICON® SK Scr 8x50</p> <p>RICON® SK Scr 5x80</p> <p>RICON® SK Scr 5x50</p> <p>RICON® Sperrbügel / stirrup</p>	<p>RICON® ISK M 8x25, M8x20</p> <p>RICON® ISK M5x20</p> <p>Verbundmutter / connecting nut M8x48, 53, 58, 78 M5x48, 53, 58, 78</p> <p>RICON® Einschraubmutter / insert M8x18</p> <p>RICON® Einschraubmutter / insert M5x14</p>
---------------------	--	---

Einzel- und Doppelanschluss  
single and double connection

Haupt-Nebenträgerverbindung  
main girder - joist connection

Hauptträger Fräsbild /Milled edge main girder

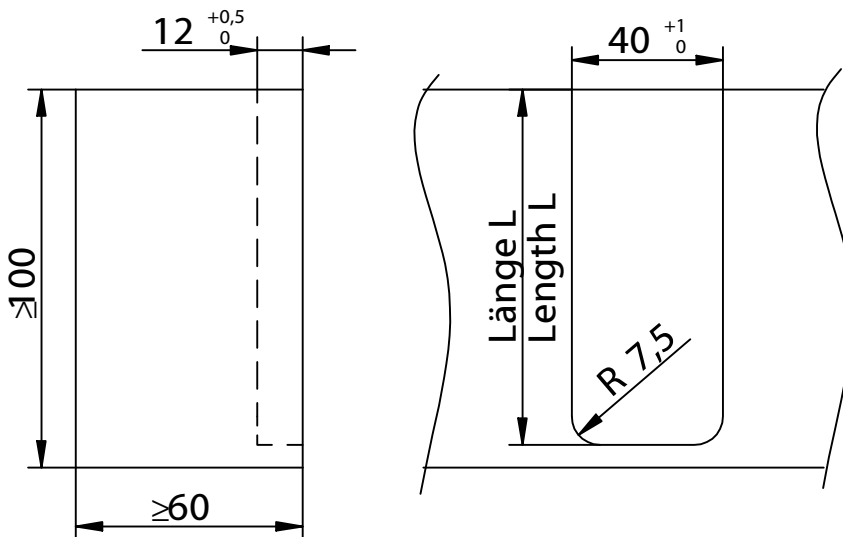

Ausfräslänge L aus dem Hauptträger in Abhängigkeit der Nebenträgerhöhe HN /  
Rebate length for main girder in reference of the height HN of the joist:

Höhe / Height HN [mm]	Länge/ Length L [mm]
100	90
120	110
140	130

Diese Zeichnung ist Eigentum der Knapp GmbH.

© Knapp GmbH. Alle Maße in mm - Irrtümer, Druckfehler und Änderungen vorbehalten. VERSION 06.11.2013

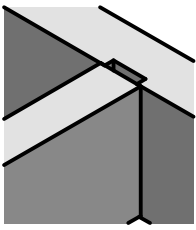

## RICON® 60/40 EA

Einzelanschluss  
single connection

Haupt-Nebenträgerverbindung  
main girder - joist connection

Art. Nr. K360

Bohrbild im Hauptträger /  
drilling template for main girder

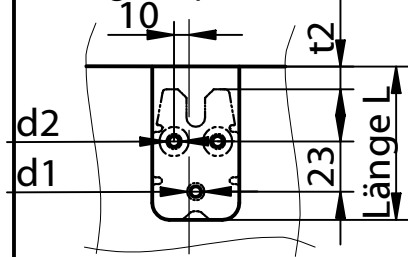

d1...Ø 5mm, 30mm tief vorbohren  
d1...Ø 5mm, 30mm deep predrilling

d2...Ø 5mm, 10mm tief vorbohren in Nadelholz  
d2...Ø 5mm, 10mm deep predrilling in softwood  
d2...Ø 3,5mm, 30mm tief vorbohren in Laubholz  
d2...Ø 3,5mm, 30mm deep predrilling in hardwood

Bohrbild im Nebenträger /  
drilling template for joist

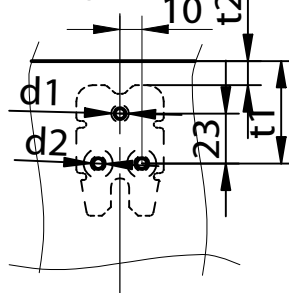

d1...Ø 5mm, 30mm tief vorbohren  
d1...Ø 5mm, 30mm deep predrilling

d2...Ø 5mm, 10mm tief vorbohren in Nadelholz  
d2...Ø 5mm, 10mm deep predrilling in softwood  
d2...Ø 3,5mm, 50mm tief vorbohren in Laubholz  
d2...Ø 3,5mm, 50mm deep predrilling in hardwood

Einbohrmaße t1 und Abstandsmaß t2 in  
Abhängigkeit der Nebenträgerhöhe HN/  
Bore measure t1 and distance t2 for joist in  
reference to the height HN of the joist

Höhe / Height HN [mm]	Abstand/ Distance t1 [mm]	Abstand/ Distance t2 [mm]
100	66	30
120	86	50
140	106	70

Schraubenbild im Hauptträger /  
screw template for main girder

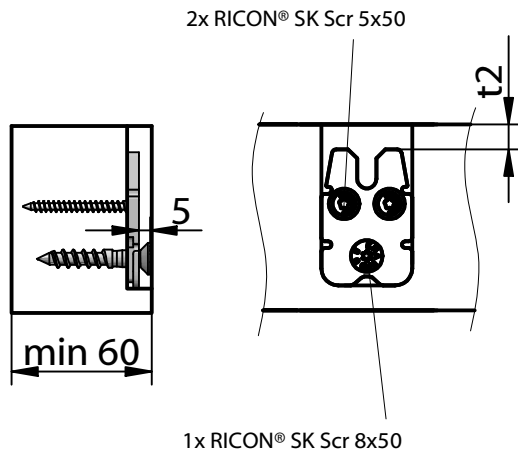

Schraubenbild im Nebenträger /  
screw template for joist

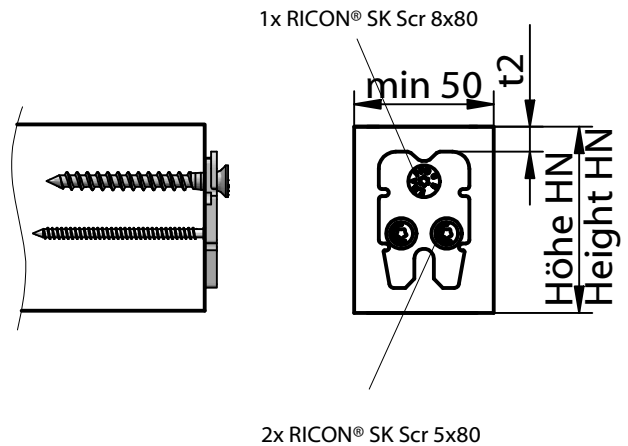

Einstellen der Schraube /  
screw position adjustment

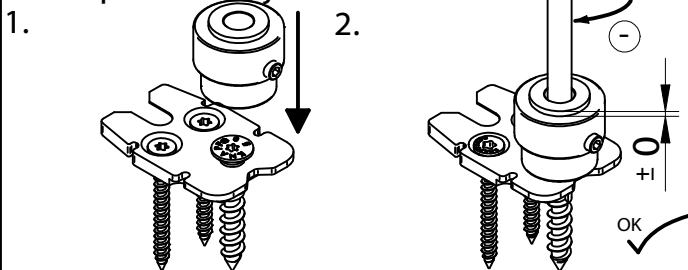

Sperrbügel einlegen /  
assemble stirrup

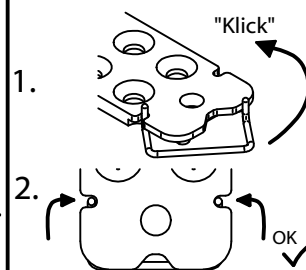

Sperrbügel lösen /  
remove stirrup

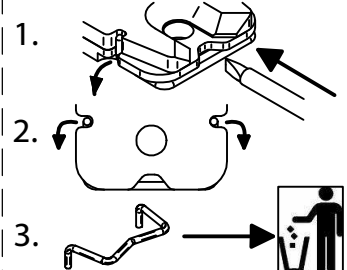

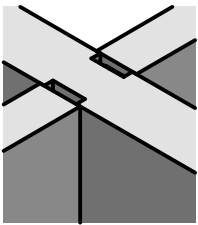

# Montageanleitung/Construction Manual

# RICON® 60/40 DA

Art. Nr. K160/48;  
K160/58; K160/78

Doppelanschluss  
double connection

Haupt-Nebenträger Verbindung  
main girder - joist connection

Bohrbild im Hauptträger /  
drilling template for main girder

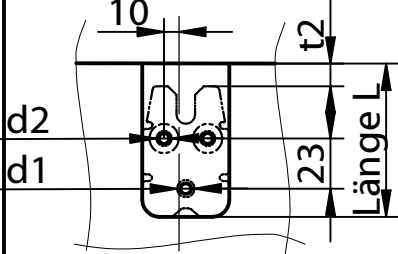

d1...Ø 10mm, Durchgangsloch  
d1...Ø 10mm, throughhole  
  
d2...Ø 8mm, Durchgangsloch  
d2...Ø 8mm, throughhole

Bohrbild im Nebenträger /  
drilling template for joist

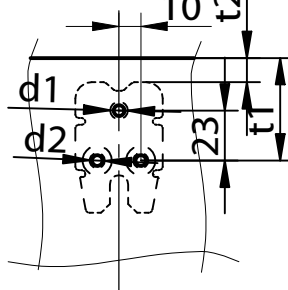

d1...Ø 5mm, 30mm tief vorbohren  
d1...Ø 5mm, 30mm deep predrilling  
  
d2...Ø 5mm, 10mm tief vorbohren in Nadelholz  
d2...Ø 5mm, 10mm deep predrilling in softwood  
d2...Ø 3,5mm, 50mm tief vorbohren in Laubholz  
d2...Ø 3,5mm, 50mm deep predrilling in hardwood

Einbohrmaße t1 und Abstandsmaß t2 in  
Abhängigkeit der Nebenträgerhöhe HN/  
Bore measure t1 and distance t2 for joist in  
reference to the height HN of the joist

Höhe / Height HN [mm]	Abstand/ Distance t1 [mm]	Abstand/ Distance t2 [mm]
100	66	30
120	86	50
140	106	70

Schraubenbild im Hauptträger /  
screw template for main girder

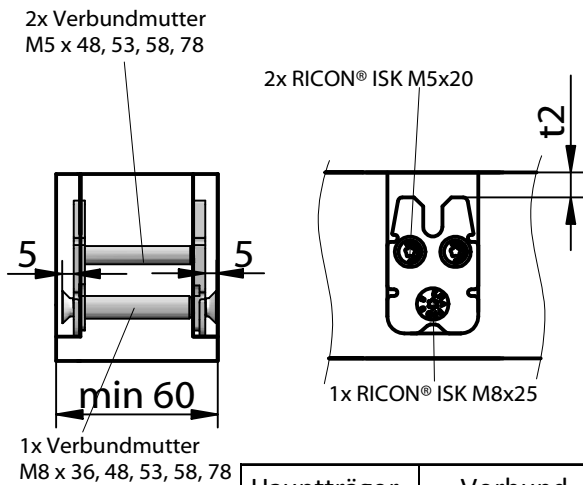

Hauptträger- stärke [mm]	Verbund- mutterlänge [mm]
60	36
80	53

Schraubenbild im Nebenträger /  
screw template for joist

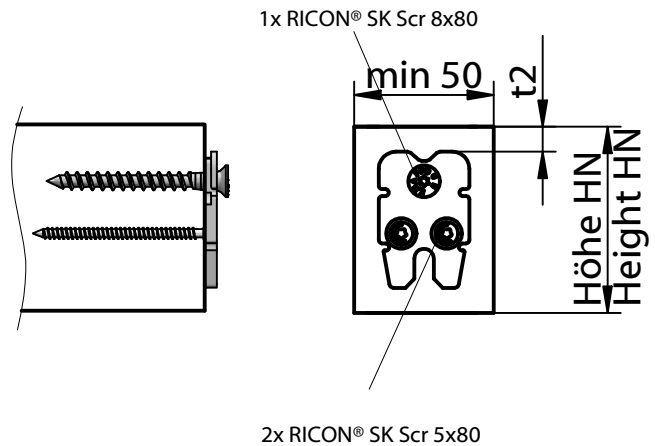

Einstellen der Schraube /  
screw position adjustment

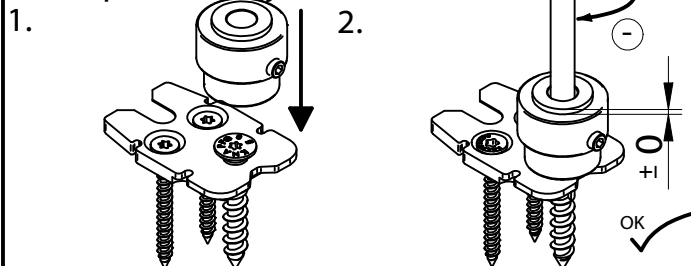

Sperrbügel einlegen /  
assemble stirrup

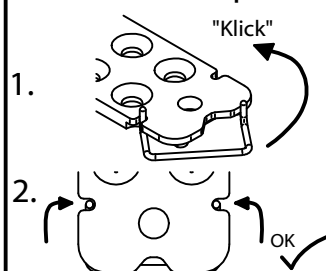

Sperrbügel lösen /  
remove stirrup

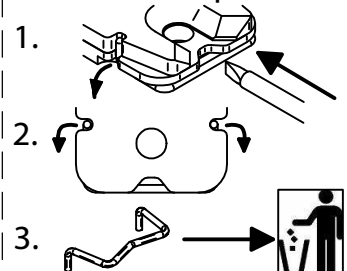

Diese Zeichnung ist Eigentum der Knapp GmbH.

© Knapp GmbH. Alle Maße in mm - Irrtümer, Druckfehler und Änderungen vorbehalten. VERSION 06.11.2013



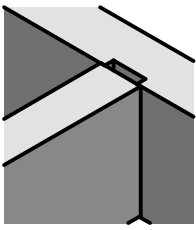

# Montageanleitung/Construction Manual

# RICON® 60/40 EAR

Art. Nr. K260

**Einzelanschluss mit Einschraubmutter**  
**single connection with insert screw**

**Haupt-Nebenträger Verbindung**  
**main girder - joist connection**

Bohrbild im Hauptträger /  
 drilling template for main girder

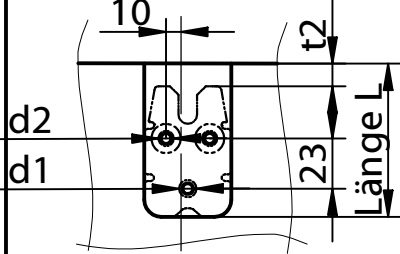

d1...Ø 12mm, 20mm tief vorbohren  
 d1...Ø 12mm, 20mm deep predrilling

d2...Ø 8mm, 15mm tief vorbohren  
 d2...Ø 8mm, 15mm deep predrilling

Bohrbild im Nebenträger /  
 drilling template for joist

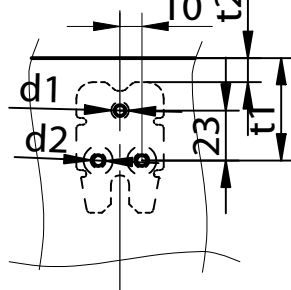

d1...Ø 5mm, 30mm tief vorbohren  
 d1...Ø 5mm, 30mm deep predrilling

d2...Ø 5mm, 10mm tief vorbohren in Nadelholz  
 d2...Ø 5mm, 10mm deep predrilling in softwood

d2...Ø 3,5mm, 50mm tief vorbohren in Laubholz  
 d2...Ø 3,5mm, 50mm deep predrilling in hardwood

Einbohrmaße t1 und Abstandsmaß t2 in  
 Abhängigkeit der Nebenträgerhöhe HN/  
 Bore measure t1 and distance t2 for joist in  
 reference to the height HN of the joist

Höhe / Height HN [mm]	Abstand/ Distance t1 [mm]	Abstand/ Distance t2 [mm]
100	66	30
120	86	50
140	106	70

Schraubenbild im Hauptträger /  
 screw template for main girder

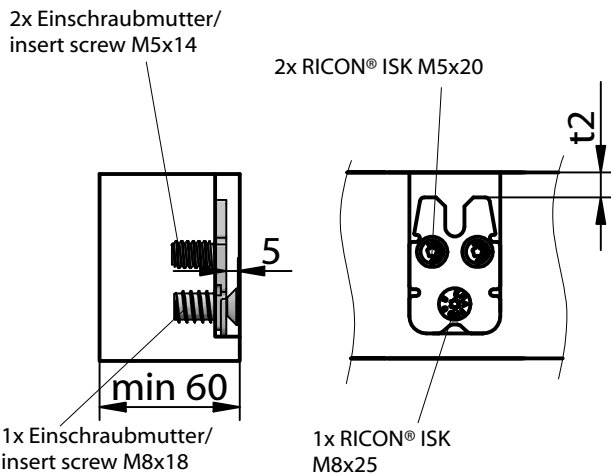

Schraubenbild im Nebenträger /  
 screw template for joist

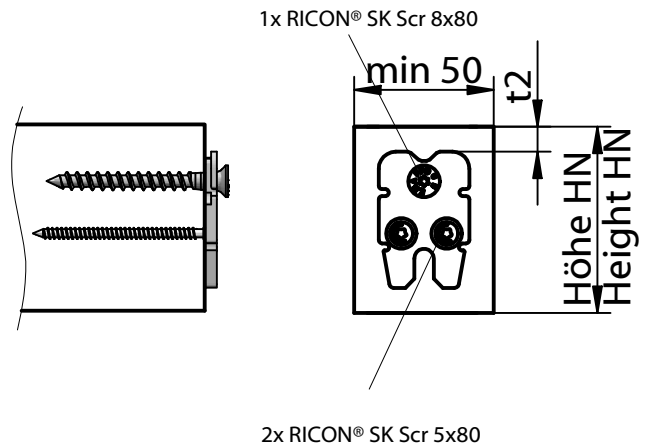

Einstellen der Schraube /  
 screw position adjustment

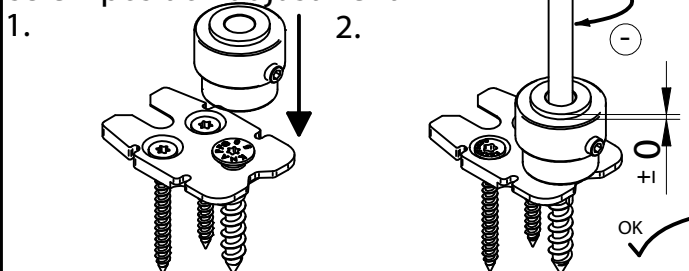

Sperrbügel einlegen /  
 assemble stirrup

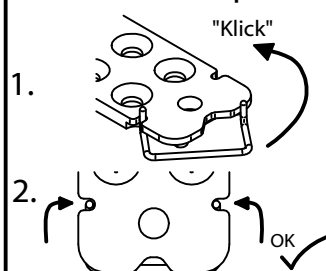

Sperrbügel lösen /  
 remove stirrup

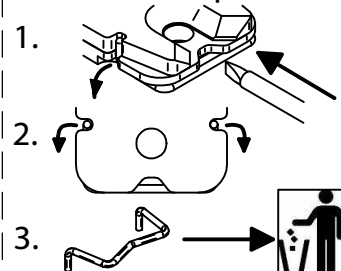

Diese Zeichnung ist Eigentum der Knapp GmbH.

© Knapp GmbH. Alle Maße in mm - Irrtümer, Druckfehler und Änderungen vorbehalten. VERSION 06.11.2013



# RICON® 60/40



ETA-10/0189

**Assemblage poteau - traverse**

avec Avis Technique (EU + DE)

**post and latch connection -**

with construction supervisory approval (EU + DE)

<p>RICON® 60/40</p>	<p>Vis RICON® SK / RICON® SK Scr 8x80</p> <p>Vis RICON® SK / RICON® SK Scr 8x50</p> <p>Vis RICON® SK / RICON® SK Scr 5x80</p> <p>Vis RICON® SK / RICON® SK Scr 5x50</p> <p>Goupille de verrouillage / stirrup</p>	<p>Vis tête fraisée, emprunte 6 pans / Countersunk socket screw M8x25, M8x20</p> <p>Vis tête fraisée, emprunte 6 pans / Countersunk socket screw M5x20</p> <p>Entretoise/ connecting nut M8x48, 53, 58, 78 M5x48, 53, 58, 78</p> <p>Insert / insert screw M8x18 Insert / insert screw M5x14</p>
---------------------	---	---

**Assemblage simple et doublé**  
Single and double connection

**Assemblage poteau - traverse**  
Latch and post connection

Détails du fraisage traverse /  
Milled edge latch

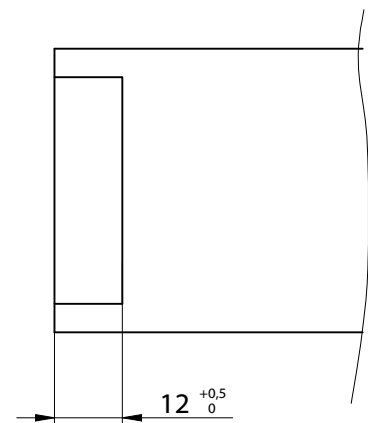
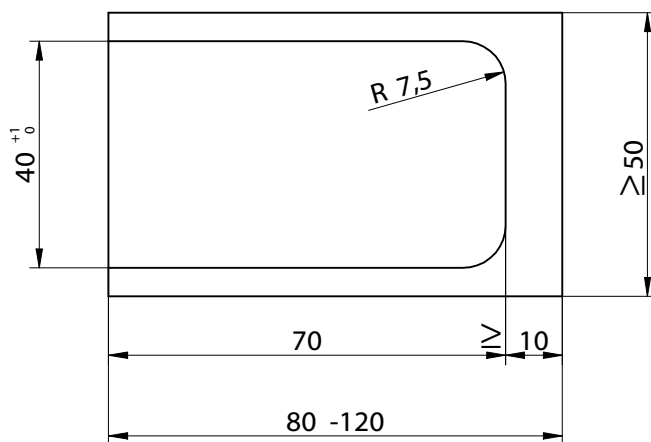

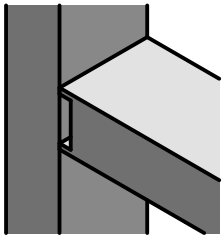

# Notice de montage/Construction Manual

# RICON® 60/40 EA

Réf. K360

Assemblage simple  
Single connection

Assemblage poteau - traverse  
Latch and post connection

## Détail du perçage sur la traverse/ Drilling template for latch

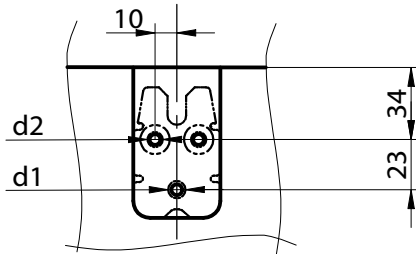

d1...pré-percer Ø 5mm, prof. 30mm  
d1...Ø 5mm, 30mm deep predrilling

d2...pré-percer Ø 5mm, prof. 10mm sur les résineux  
d2...Ø 5mm, 10mm deep predrilling (softwood)

d2...pré-percer Ø 3,5mm, prof. 50mm sur les feuillu  
d2...Ø 5mm, 10mm deep predrilling (hardwood)

## Détail du perçage sur le poteau/ Drilling template for post

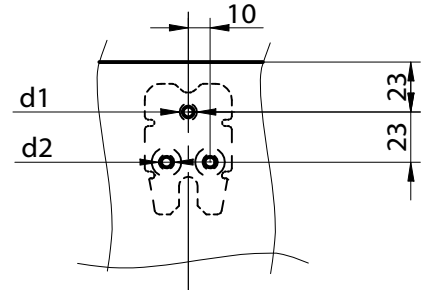

d1...pré-percer Ø 5mm, prof. 30mm  
d1...Ø 5mm, 30mm deep predrilling

d2...pré-percer Ø 5mm, prof. 10mm  
d2...Ø 5mm, 10mm deep predrilling

## Détail du vissage sur la traverse / screw template for latch

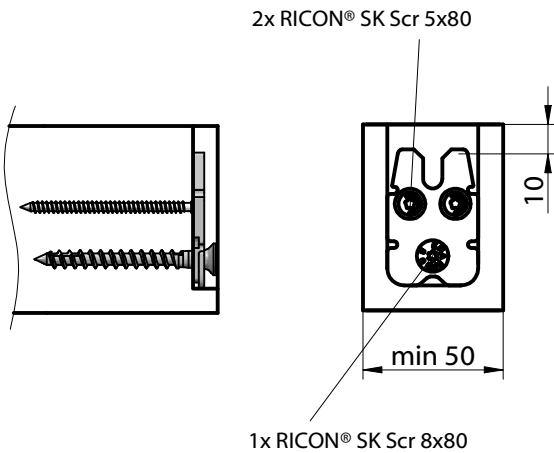

## Détail du vissage sur le poteau/ Screw template for post

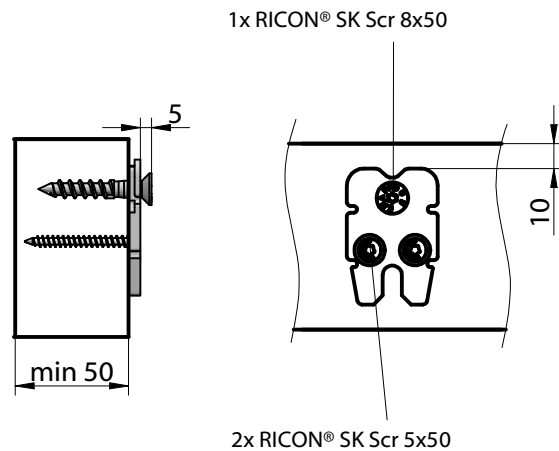

Ce dessin est la propriété de Knapp GmbH.

## Régler la vis d'accroche / Screw position adjustment

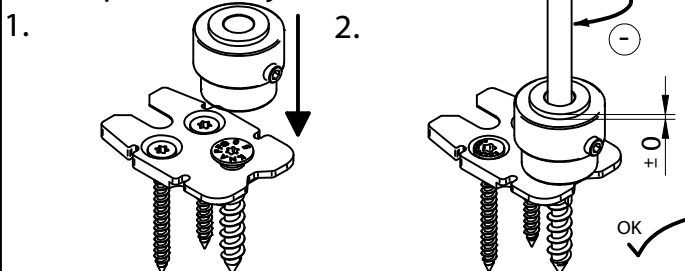

## Mettre la goupille en place/ Assemble stirrup

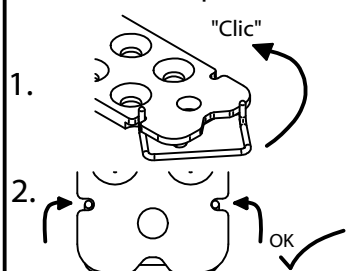

## Déverrouiller la goupille / Remove stirrup

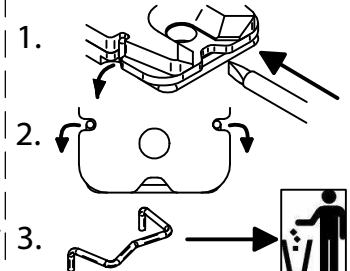

© Knapp GmbH. Toutes dimensions en mm - sauf erreurs, fautes d'impression ou modifications techniques. VERSION 06.11.2013

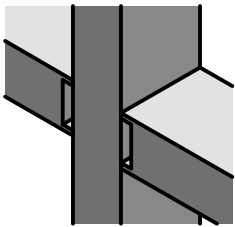

# RICON® 60/40 DA

Réf. K160/48;  
K160/58; K160/78

Assemblage doublé  
Double connection

Assemblage poteau - traverse  
Latch and post connection

## Détail du perçage sur la traverse / Drilling template for latch

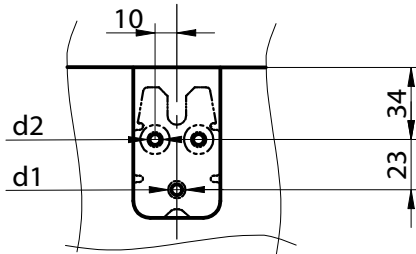

d1...pré-percer Ø 5mm, prof. 30mm  
d1...Ø 5mm, 30mm deep predrilling

d2...pré-percer Ø 5mm, prof. 10mm sur les résineux  
d2...Ø 5mm, 10mm deep predrilling (softwood)

d2...pré-percer Ø 3,5mm, prof. 50mm sur les feuillus  
d2...Ø 5mm, 10mm deep predrilling (hardwood)

## Détail du perçage sur le poteau / Drilling template for post

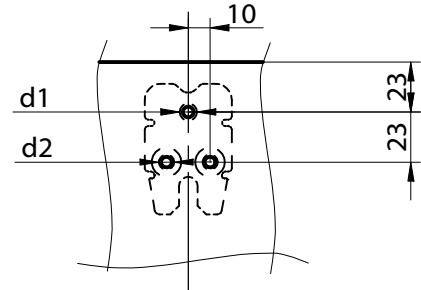

d1...pré-percer en traversant Ø 10mm,  
d1...Ø 10mm, throughhole

d2...pré-percer en traversant Ø 8mm  
d2...Ø 8mm, throughhole

## Détail du vissage sur la traverse / screw template for latch

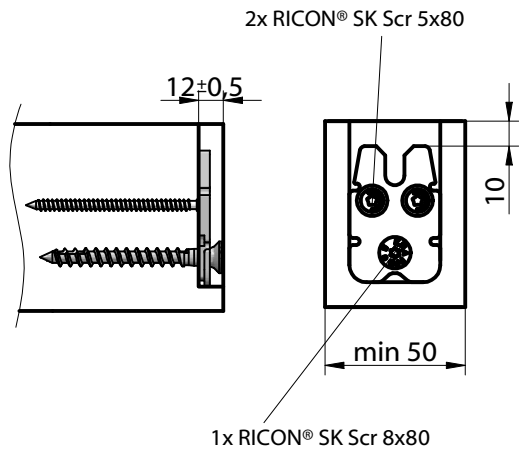

## Détail du vissage sur le poteau / Screw template for post

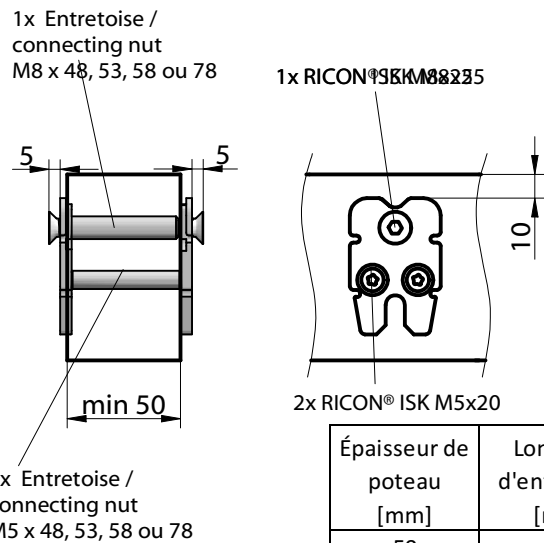

Épaisseur de poteau [mm]	Longueur d'entretoise [mm]
50	48
56	53
60	58
80	78

Ce dessin est la propriété de Knapp GmbH.

## Régler la vis d'accroche / Screw position adjustment

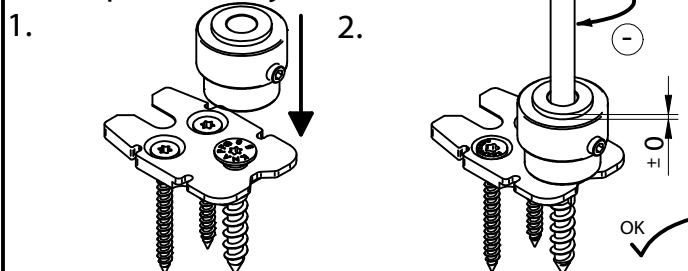

## Mettre la goupille en place / Assemble stirrup

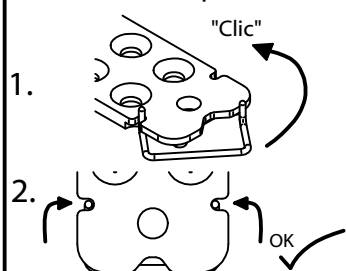

## Déverrouiller la goupille / Remove stirrup

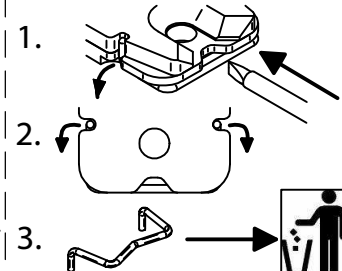

© Knapp GmbH. Toutes dimensions en mm - sauf erreurs, fautes d'impression ou modifications techniques. VERSION 06.11.2013

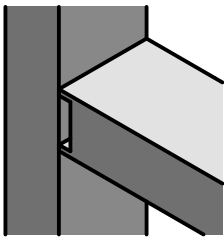

# Notice de Montage/Construction Manual

# RICON® 60/40 EAR

**Réf. K260**

Assemblage simple avec insert

Single connection with insert screw

Assemblage poteau - traverse

Latch and post connection

Détail du perçage sur la traverse /  
Drilling template for latch

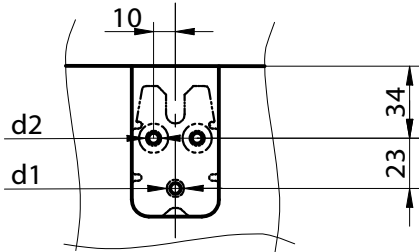

d1...pré-percer Ø 5mm, prof. 30mm  
d1...Ø 5mm, 30mm deep predrilling

d2...pré-percer Ø 5mm, prof. 10mm sur les résineux  
d2...Ø 5mm, 10mm deep predrilling (softwood)  
d2...pré-percer Ø 3,5mm, prof. 50mm sur les feuillus  
d2...Ø 5mm, 10mm deep predrilling (hardwood)

Détail du perçage sur le poteau /  
Drilling template for post

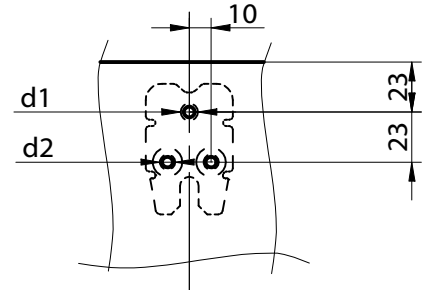

d1...pré-percer Ø 12mm, prof. 20mm  
d1...Ø 12mm, 20mm deep predrilling

d2...pré-percer Ø 8mm, prof. 15mm  
d2...Ø 8mm, 15 mm deep predrilling

Détail du vissage sur la traverse /  
screw template for latch

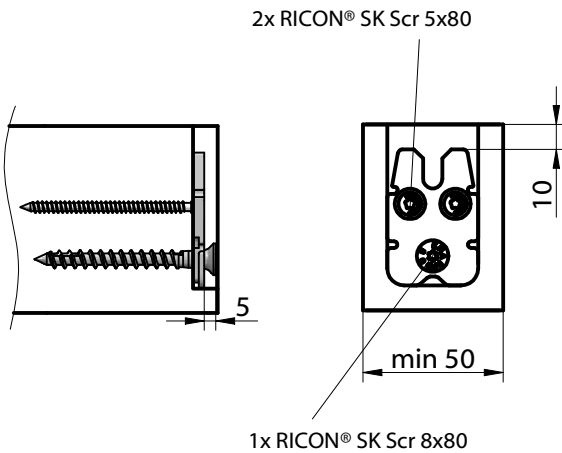

Détail du vissage sur le poteau /  
Screw template for post

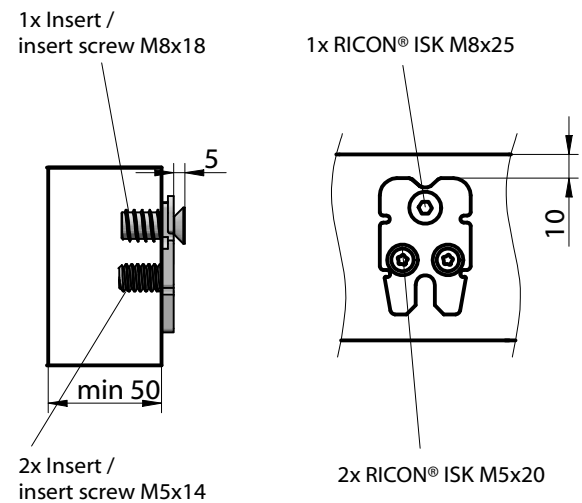

Ce dessin est la propriété de Knapp GmbH.

Régler la vis d'accroche /  
Screw position adjustment

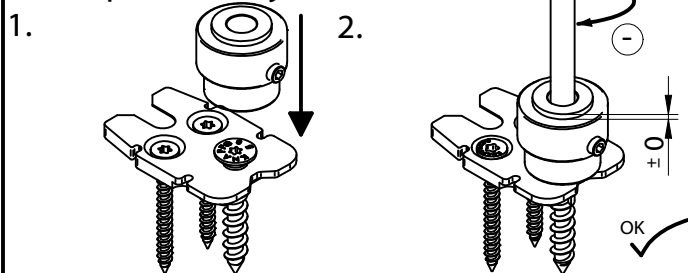

Mettre la goupille en place /  
Assemble stirrup

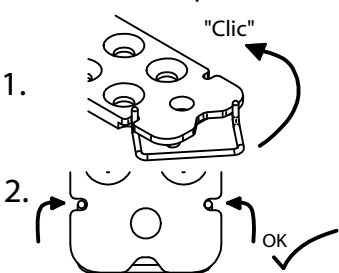

Déverrouiller la goupille /  
Remove stirrup

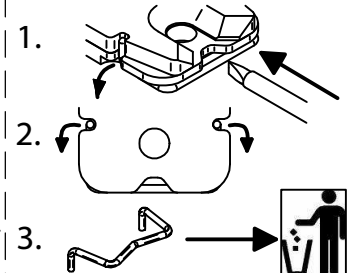

© Knapp GmbH. Toutes dimensions en mm - sauf erreurs, fautes d'impression ou modifications techniques. VERSION 06.11.2013

# RICON® 60/40

## Assemblage de poutre secondaire sur principale

- avec Avis Technique (EU + DE)

### Main girder- joist connection

- with construction supervisory approval (EU + DE)



ETA-10/0189

**RICON® 60/40**

Vis RICON® SK /  
RICON® SK Scr 8x80

Vis RICON® SK /  
RICON® SK Scr 8x50

Vis RICON® SK /  
RICON® SK Scr 5x80

Vis RICON® SK /  
RICON® SK Scr 5x50

Goupille de verrouillage /  
stirrup

Vis tête fraisée, emprunte 6 pans /  
Countersunk socket screw  
M8x25, M8x20

Vis tête fraisée, emprunte 6 pans /  
Countersunk socket screw M5x20

Entretoise/ connecting nut  
M8x48, 53, 58, 78  
M5x48, 53, 58, 78

Insert / insert screw M8x18  
Insert / insert screw M5x14

Assemblage simple et doublé  
Single and double connection

Poutre secondaire sur principale  
Main girder - joist connection

Détails du fraisage poutre principale/  
Milled edge main girder

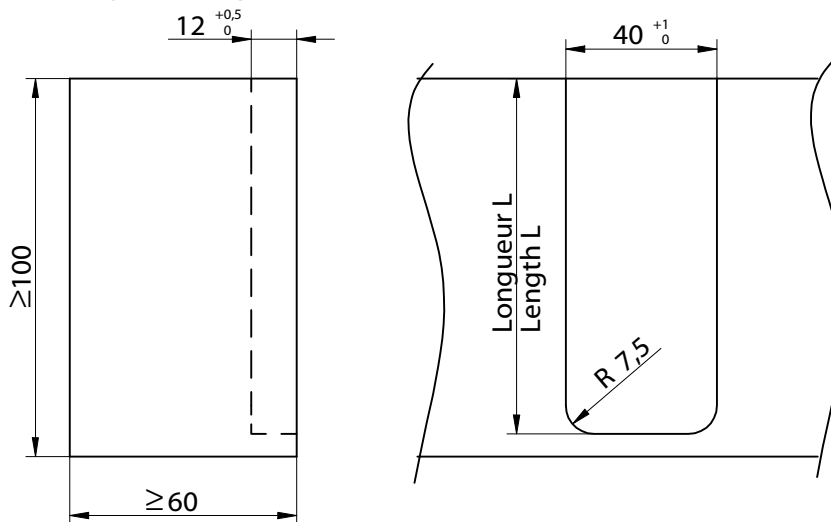

Long. de fraisage L sur pièce principale, en relation avec Ht. pièce secondaire HN /  
Rebate length for main girder in reference of the height HN of the joist:

Hauteur / Height HN [mm]	Long. / Length L [mm]
100	90
120	110
140	130

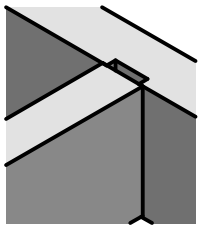

# Notice de montage/Construction Manual

## RICON® 60/40 EA

Assemblage simple  
Single connection

Poutre secondaire sur principale  
Main girder - joist connection

Réf. K360

Détail du perçage sur la poutre principale / Drilling template for main girder

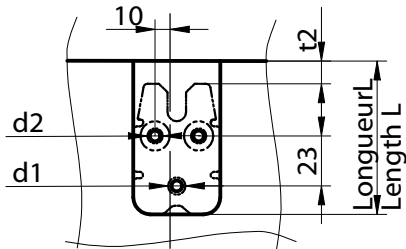

d1...pré-percer Ø 5mm, prof. 30mm  
d1...Ø 5mm, 30mm deep predrilling

d2...pré-percer Ø 5mm, prof. 10mm  
d2...Ø 5mm, 10mm deep predrilling

Détail du perçage sur la poutre secondaire / Drilling template for joist

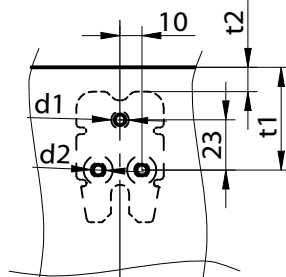

d1...pré-percer Ø 5mm, prof. 30mm  
d1...Ø 5mm, 30mm deep predrilling

d2...pré-percer Ø 5mm, prof. 10mm sur les résineux  
d2...Ø 5mm, 10mm deep predrilling (softwood)  
d2...pré-percer Ø 3,5mm, prof. 50mm sur les feuillus  
d2...Ø 5mm, 10mm deep predrilling (hardwood)

Distance de perçage t1 et t2, en relation avec la hauteur de la pièce secondaire HN / Bore measure t1 and distance t2 for joist in reference to the height HN of the joist

Hauteur / Height HN [mm]	Distance t1 [mm]	Distance t2 [mm]
100	66	30
120	86	50
140	106	70

Détail du vissage sur la poutre principale / Screw template for main girder

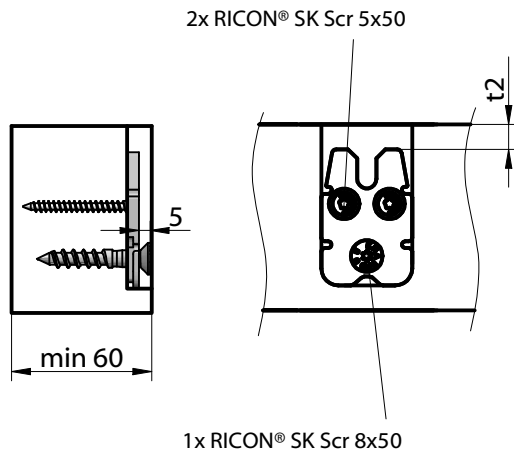

Détail du vissage sur la poutre secondaire / Screw template for joist

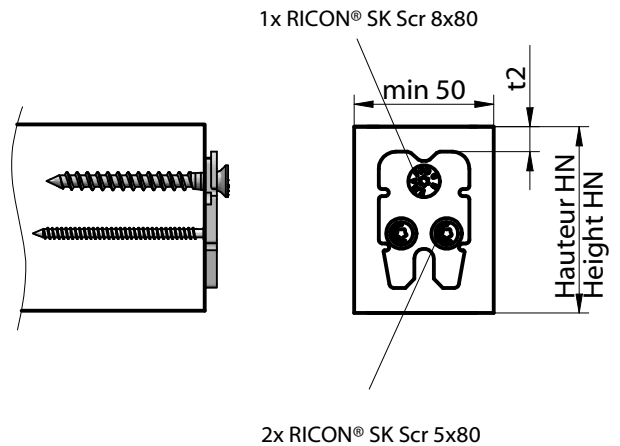

Ce dessin est la propriété de Knapp GmbH.

Régler la vis d'accroche / Screw position adjustment

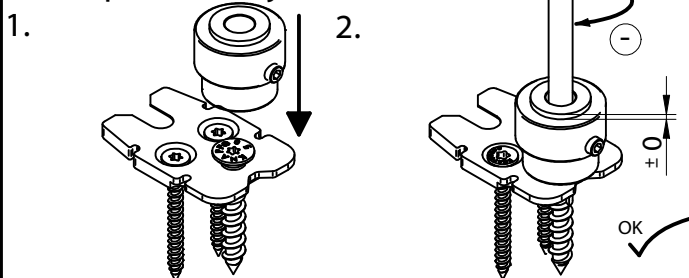

Mettre la goupille en place / Assemble stirrup

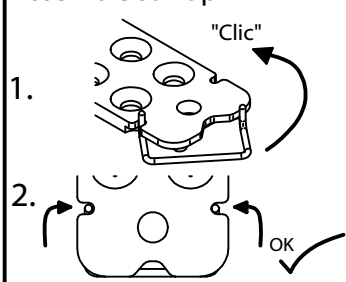

Déverrouiller la goupille / Remove stirrup

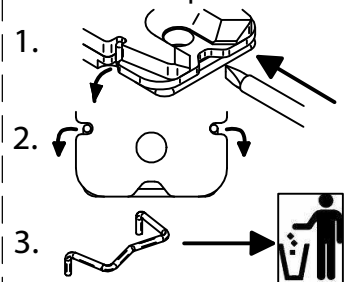

© Knapp GmbH. Toutes dimensions en mm - sauf erreurs, fautes d'impression ou modifications techniques. VERSION 06.11.2013



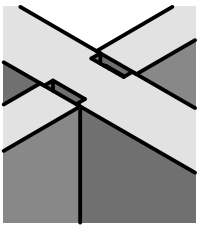

# Notice de Montage/Construction Manual

# RICON® 60/40 DA

Assemblage doublé  
Double connection

Poutre secondaire sur principale  
Main girder - joist connection

Réf. K160/48;  
K160/58; K160/78

Détail du perçage sur la poutre principale / Drilling template for main girder

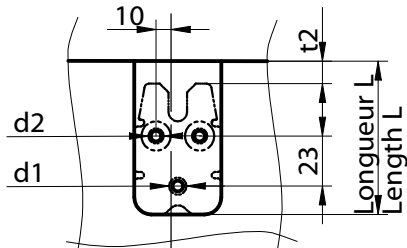

d1...pré-percer en traversant Ø 10mm,  
d1...Ø 10mm, throughhole

d2...pré-percer en traversant Ø 8mm  
d2...Ø 8mm, throughhole

Détail du perçage sur la poutre secondaire / Drilling template for joist

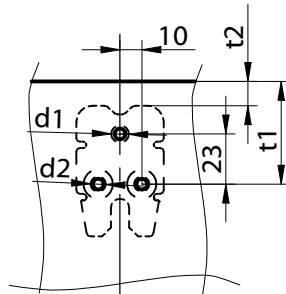

d1...pré-percer Ø 5mm, prof. 30mm  
d1...Ø 5mm, 30mm deep predrilling

d2...pré-percer Ø 5mm, prof. 10mm sur les résineux  
d2...Ø 5mm, 10mm deep predrilling (softwood)  
d2...pré-percer Ø 3,5mm, prof. 50mm sur les feuillus  
d2...Ø 5mm, 10mm deep predrilling (hardwood)

Distance de perçage t1 et t2, en relation avec la hauteur de la pièce secondaire HN / Bore measure t1 and distance t2 for joist in reference to the height HN of the joist

Hauteur / Height HN [mm]	Distance t1 [mm]	Distance t2 [mm]
100	66	30
120	86	50
140	106	70

Détail du vissage sur la poutre principale / Screw template for main girder

2x entretoises / connecting nut  
M5 x 48, 53, 58 ou 78

2x RICON® ISK M5x20

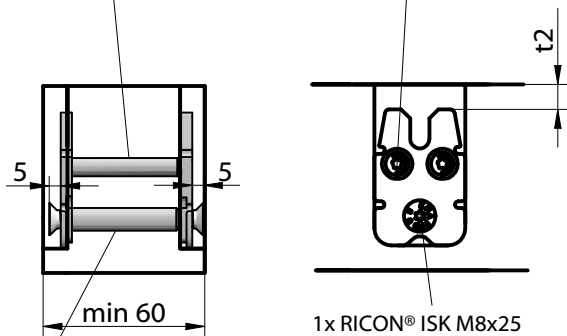

1x entretoises / connecting nut  
M8 x 48, 53, 58 ou 78

Ép. de pièce principale [mm]	Longueur d'entretoise [mm]
60	36
80	53

Détail du vissage sur la poutre secondaire / Screw template for joist

1x RICON® SK Scr 8x80

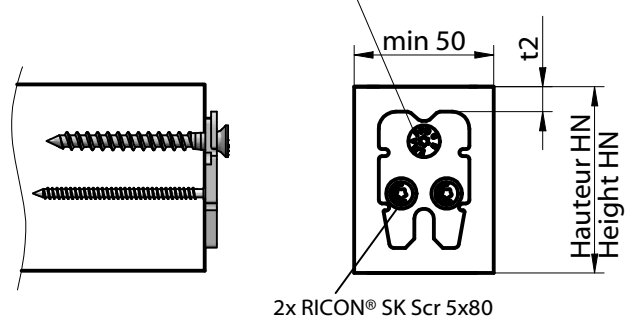

2x RICON® SK Scr 5x80

Ce dessin est la propriété de Knapp GmbH.

Régler la vis d'accroche / Screw position adjustment

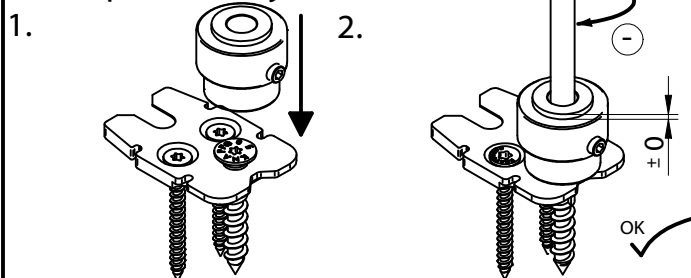

Mettre la goupille en place / Assemble stirrup

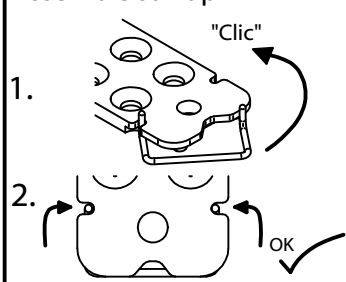

Déverrouiller la goupille / Remove stirrup

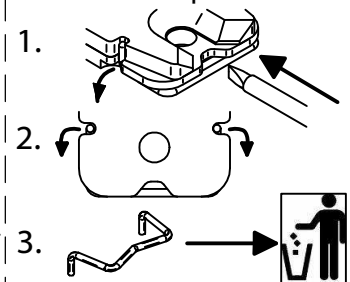

© Knapp GmbH. Toutes dimensions en mm - sauf erreurs, fautes d'impression ou modifications techniques. VERSION 06.11.2013

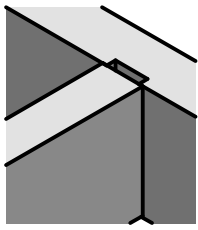

# Notice de Montage/Construction Manual

# RICON® 60/40 EAR

Assemblage simple avec insert Poutre secondaire sur principale  
 Single connection with insert screw Main girder - joist connection

Réf. K260

Détail du perçage sur la poutre principale / Drilling template for main girder

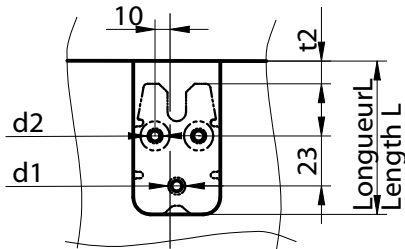

d1...pré-percer Ø 12mm, prof. 20 mm  
 d1...Ø 12mm, 20 mm deep predrilling

d2...pré-percer .Ø 8mm, prof. 15mm  
 d2...Ø 8mm, 15mm deep predrilling

Détail du perçage sur la poutre secondaire / Drilling template for joist

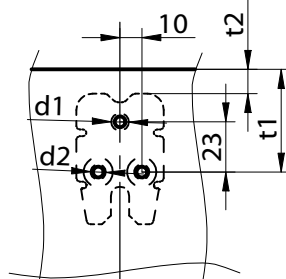

d1...pré-percer Ø 5mm, prof. 30mm  
 d1...Ø 5mm, 30mm deep predrilling

d2...pré-percer Ø 5mm, prof. 10mm sur les résineux  
 d2...Ø 5mm, 10mm deep predrilling (softwood)  
 d2...pré-percer Ø 3,5mm, prof. 50mm sur les feuillus  
 d2...Ø 3,5mm, 50mm deep predrilling (hardwood)

Distance de perçage t1 et t2, en relation avec la hauteur de la pièce secondaire HN / Bore measure t1 and distance t2 for joist in reference to the height HN of the joist

Hauteur / Height HN [mm]	Distance t1 [mm]	Distance t2 [mm]
100	66	30
120	86	50
140	106	70

Détail du vissage sur la poutre principale / Screw template for main girder

2x Insert / insert screw M5x14

2x RICON® ISK M5x20

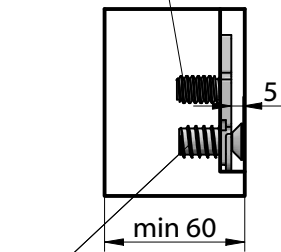

1x Insert / insert screw M8x18

1x RICON® ISK M8x25

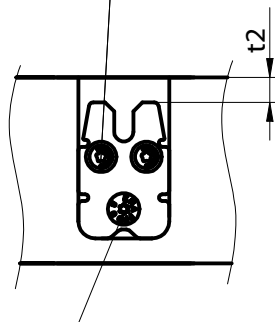

Détail du vissage sur la poutre secondaire / Screw template for joist

1x RICON® SK Scr 8x80

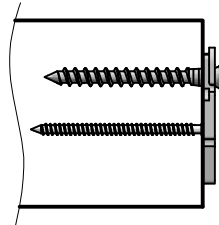

2x RICON® SK Scr 5x80

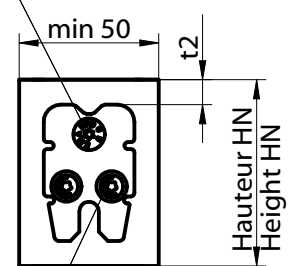

Ce dessin est la propriété de Knapp GmbH.

Régler la vis d'accroche / Screw position adjustment

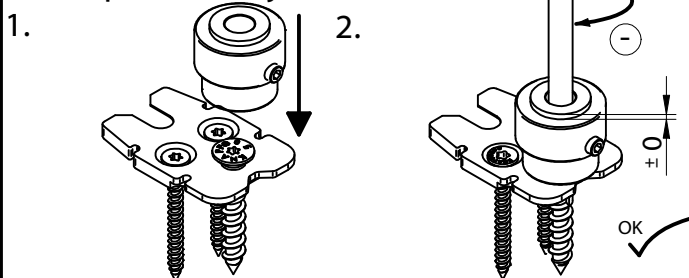

Mettre la goupille en place / Assemble stirrup

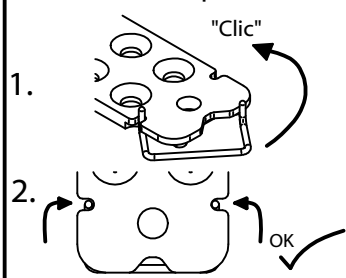

Déverrouiller la goupille / Remove stirrup

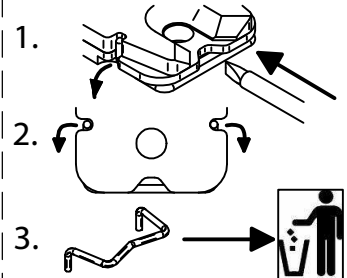

© Knapp GmbH. Toutes dimensions en mm - sauf erreurs, fautes d'impression ou modifications techniques. VERSION 06.11.2013